



# Culture Builds Communities

A project of the Association of Tribal Archives,  
Libraries and Museums

funded by the

Institute of Museum and Library Services  
and the  
National Museum of the American Indian

# Models of Success: An Introduction to Raising Funds for Cultural Facilities

---

Presented by Don Chalmers  
SparrowHawk Consulting  
May 2020

# About Don Chalmers

---

- Established Sparrowhawk Consulting in 1984 to serve non-profits and Tribes
- Extensive experience working with Tribes and Tribal communities
- Adjunct Faculty, The Evergreen State College
- [don@sparrowhawkco.com](mailto:don@sparrowhawkco.com) (360) 280-0511

# Specializing in helping Native Communities

*Identify and  
secure funding  
for  
Cultural  
facilities.*

House of  
Knowledge,  
Port Gamble  
S'Klallam Tribe





# During the webinar we will cover:

---

- An overview of the fundraising process, including conducting a funding feasibility study, establishing goals, organizing a team, identifying sources, and drafting a **Case for Support** highlighted through case studies.

# This webinar

---

- Shares how Native communities have successfully raised funds from a variety of sources.
- Provides examples of Tribes and effective non-profits which have benefited community development through museums and libraries.

# Assess Your Community

- Develop a Community Assessment Plan
  - Include Data
  - Include Surveys, Interviews and Focus Groups
  - Community Gatherings

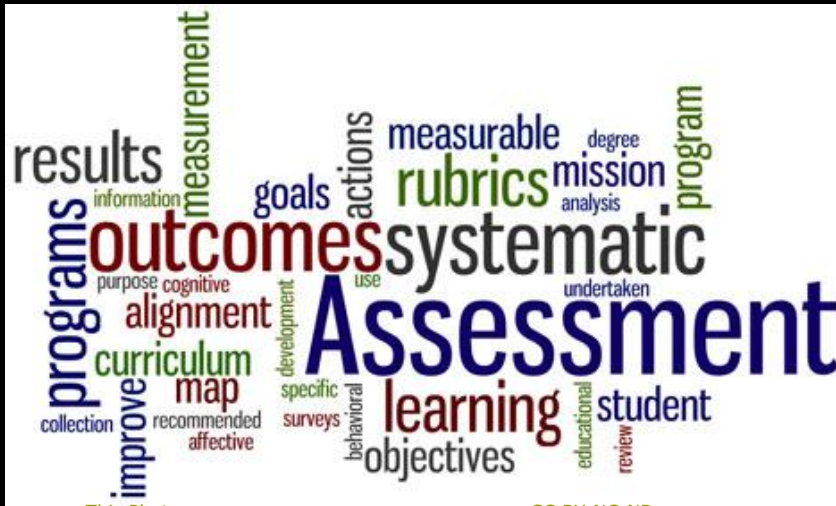

This Photo by Unknown Author is licensed under [CC BY-NC-ND](https://creativecommons.org/licenses/by-nc-nd/4.0/)

# 6 Community Assessment Steps:

---

- **Step 1: Define the Scope**
- **Step 2: Decide to Go Solo or Collaborate**
- **Step 3: Collect Data**
- **Step 4: Determine Key Findings**
- **Step 5: Set Priorities and Create an Action Plan**
- **Step 6: Share Your Findings**

A Guide to Community Assessment is included.



# A Useful Guide:

---

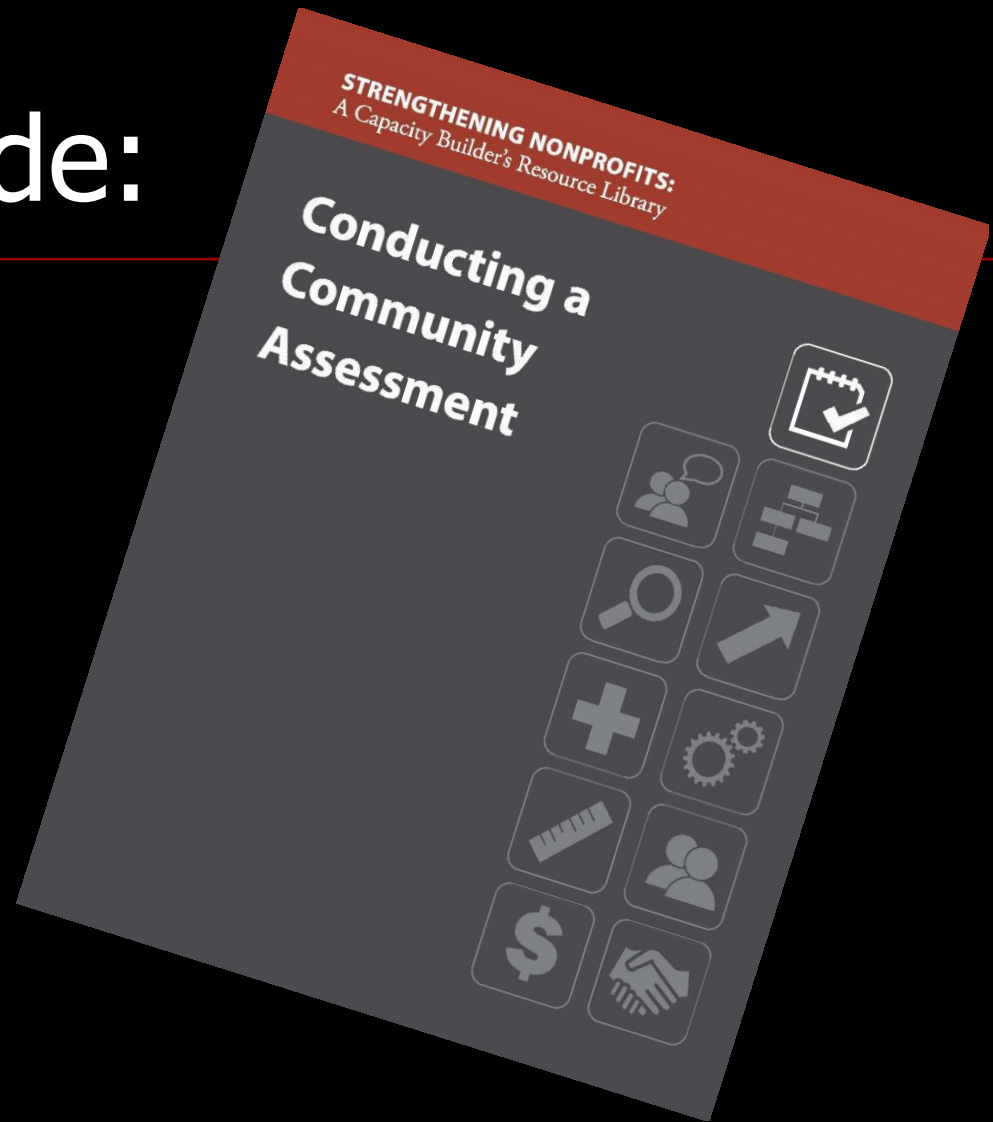



# Articulate Your Program/Project Collaboratively

Component:	Year 1	Comments and Ongoing Costs
a brief description of the initiative		
a target timeline for implementation of each component of the initiative	Component A: Component B: Component C: Component D:	
the departments to be involved in the initiative		
the outcomes anticipated from the initiative		
a rough estimate of first year and ongoing costs of the initiative		
those responsible for overseeing completion of the initiative		

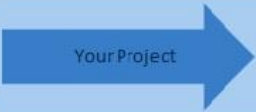

# Find the Right Funder Tool

	1	2	3	4	5	6	7	8	
	Money	Time	Subject Matter	Type of Support	Public/Private	Geography	Eligibility	Contacts	
Basic Questions to Ask: Don't Skip Over Any Screen!	How Much is Needed for the Project?	When Do You Need the Resources?  For How Long Do You Need the Resources?	What is the Focus of the Project?	How Will the Resources Be Used?	Does the Funder Accept Applications from Tax-Supported Organizations or Agencies?	Where Can the Funder's Resources be Used?	Is the Applicant Eligible to Apply for this Funder's Resources?	Does the Applicant have a Relationship with People Associated with the Funder?	
Hints	What is the largest grant made? Average Grant? Will you leverage this funder's grant with those of other funders?	Do you need funding soon? Recognize the time each funder needs to consider your request: e.g., Gates Foundation 5-7 months. Does this funder fund multi-year projects?	Be careful how you characterize the subject matter: different audiences respond differently to the same concept depending on how it's presented.	What kind of support are you seeking? General Operating Support, Building Funds, Scholarships, etc. Make sure this funder provides that kind of support.	Some funders will not fund organizations that are primarily funded with taxes like public colleges & universities, counties, etc.	Be cautious about interpreting ambiguous language ("giving primarily in Seattle & King County") as inclusive.	Does the funder have specific eligibility requirements? E.g., you must be a non-profit, a Tribe, a College or University, etc. Recognize the power of partnerships in this screen.	Know a donor, a trustee, a staff member or a funder consultant? Avoid end runs by going directly to Trustees without informing staff.	

# Funding Feasibility Studies

- Determine if funding is available & other key information
- Interview foundations, corporations, individuals, others
- Often required by funders, but many are not willing to fund these studies
- Use results to determine whether to go forward or do additional work 1st

# Feasibility Studies (Cont'd)

- Need a representative sample
- Confidential!  
Usually contracted
- A Test Case Statement is key
- Time consuming for the contractor, but can be conducted in 6 weeks



# Resource

---

- Sample Executive Summary (see handouts)

# Tribal non-profit success stories



# Tribal non-profit success stories



- **Port Gamble S'Klallam Tribe and Foundation**

Initially created to augment fundraising for capital campaign, it has become an important source of program and capital funding for the Tribe.

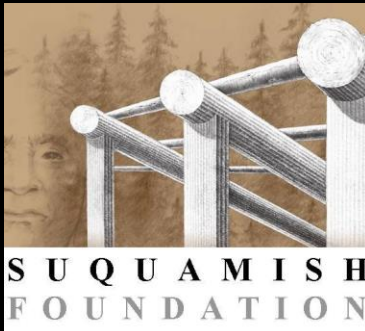

- **Suquamish Tribe and Foundation**

This foundation has completed a \$19 million capital campaign and was named one of Potlatch Fund's Philanthropists of the Year in 2007.

# Squaxin Island Museum Library Research Center

---

<https://squaxinilandmuseum.org/>



# Facts and Figures

---

- \$3.1 Million
- A fully-conditioned 13,000 square foot eco-museum near Shelton Washington.
- Designed by Walter Schacht, FAIA
- Part of a complex of buildings including the Administration Center, Veterans Memorial and Elders Center



# House of Sacred Belongings

---





# Port Gamble S'Klallam House of Knowledge Project



- Elder Mary John's Dream
- \$5 million in capital projects

# The House of Knowledge Project

---

- Adds to the Port Gamble Reservation:
  - Their first longhouse in over 100 years
  - A new Career and Education Center
  - A new Elders Center
  - A new Little Boston Library

## Facts and Figures

---



\$5 Million Campaign



Buildings built in order:  
Longhouse, Career and  
Education Center, Elders  
Center and Library



Designed by Ray  
Johnston Architects in  
collaboration with  
James Cutler

# Keys to Success

---

- Drawn from the Vision and Dreams of the Elders
- Broad-based, Dedicated Campaign Committee
- Strong Support from Council and Tribal Administration
- Innovative Special Events
- Regular Volunteer Updates

# Keys to Success

---

- Strong support from Tribal Executive Staff and Tribal Chairman
- The Port Gamble S'Klallam Foundation
- Strong Local Community support
- Regular Communication
- Resurgence among the Youth
- Use of local reservation resources
- Collaboration with other Native People
- Active Campaign Committee & 100 Volunteers

# Keys (Cont'd)

---

- Innovative Special Events
- Regular Volunteer Updates





# The Port Gamble S'Klallam Foundation

---

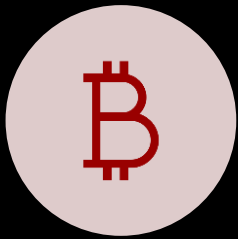

CONVERTED FROM THE  
KLALLAM DEVELOPMENT  
FUND (DORMANT)



INITIALLY STAFFED BY  
TRIBAL EMPLOYEES



QUID PRO QUO AGREEMENT  
FOR ACCOUNTING AND  
OTHER SERVICES



[HTTPS://WWW.SK LALLAMFO  
UNDATION.ORG/](https://www.sklallamfoundation.org/)

# Having the Port Gamble S'Klallam Foundation offered several advantages

---



Some State of Washington funds (nearly \$200,000) were not available to the Tribe



Many private foundations preferred to contribute to the Foundation-Murdock Trust, e.g.



Local residents made substantial personal gifts to the Foundation



HOK donations empowered the Foundation to seek support for other projects



Special Events Added  
nearly \$100,000

# The Longhouse From Start to Finish

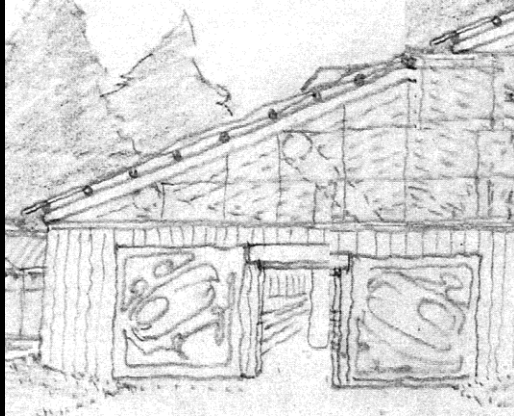

# Port Gamble S'Klallam Longhouse Dedication

---







Longhouse Interior

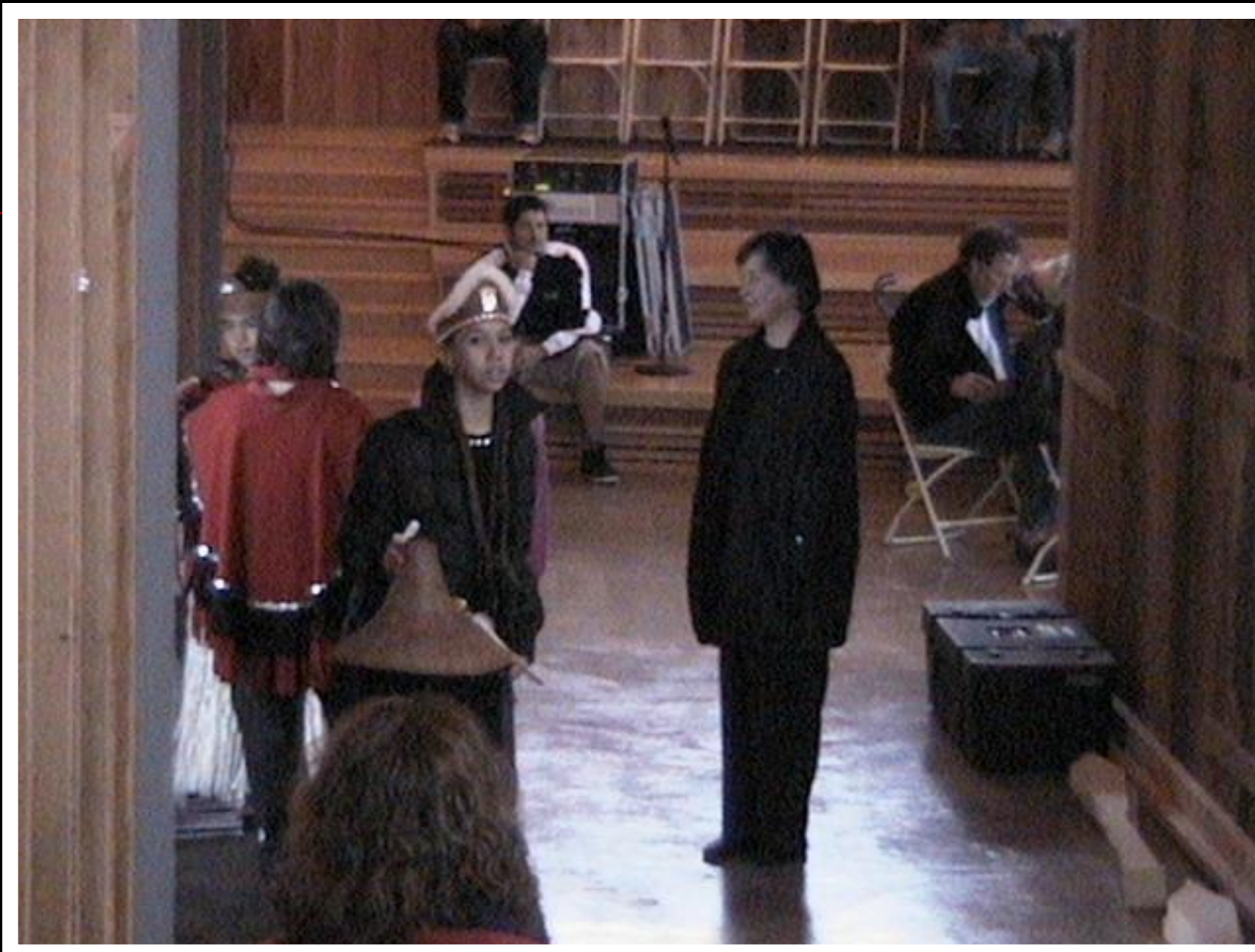

Laurie Mattson, Project Coordinator  
Greets Guests





The West Entrance



The West Entrance with Totems



The East Entrance with Totems



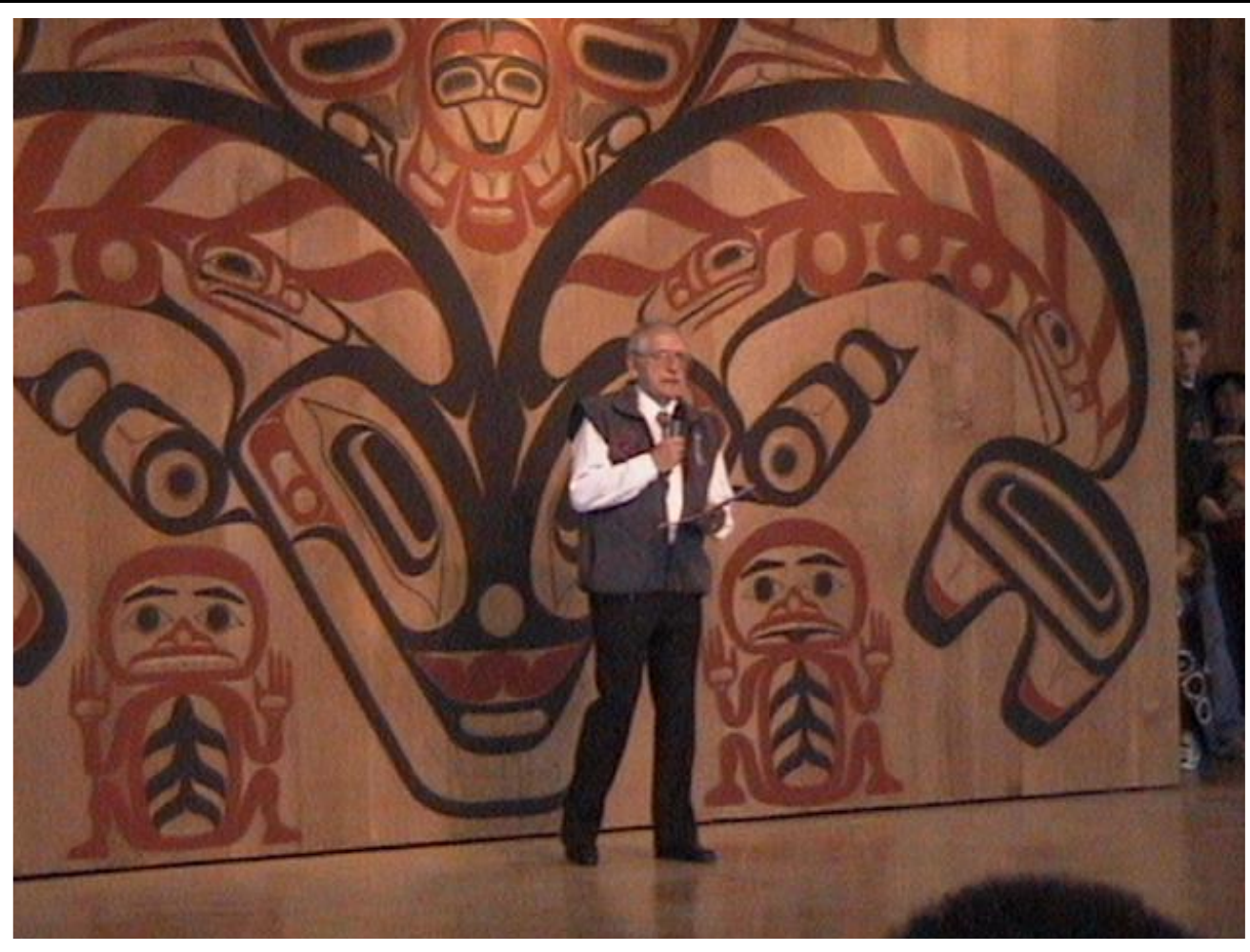

Chairman Ron Charles Greets Visitors

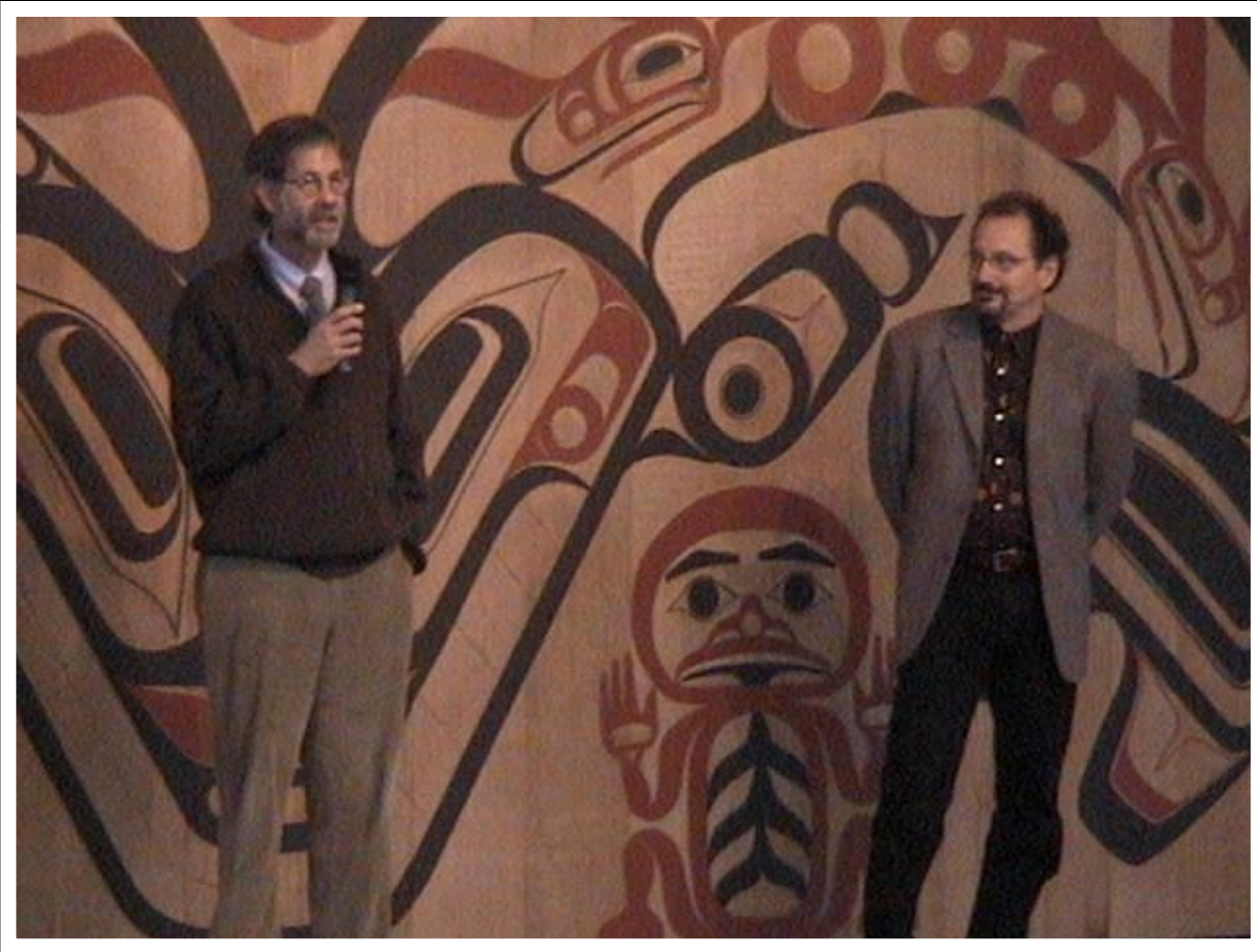

Two of the Project Architects



Elders Who Named the House of Knowledge





A Young Dancer with Salmon Mask



## The Carvers







## An Honoring Dance

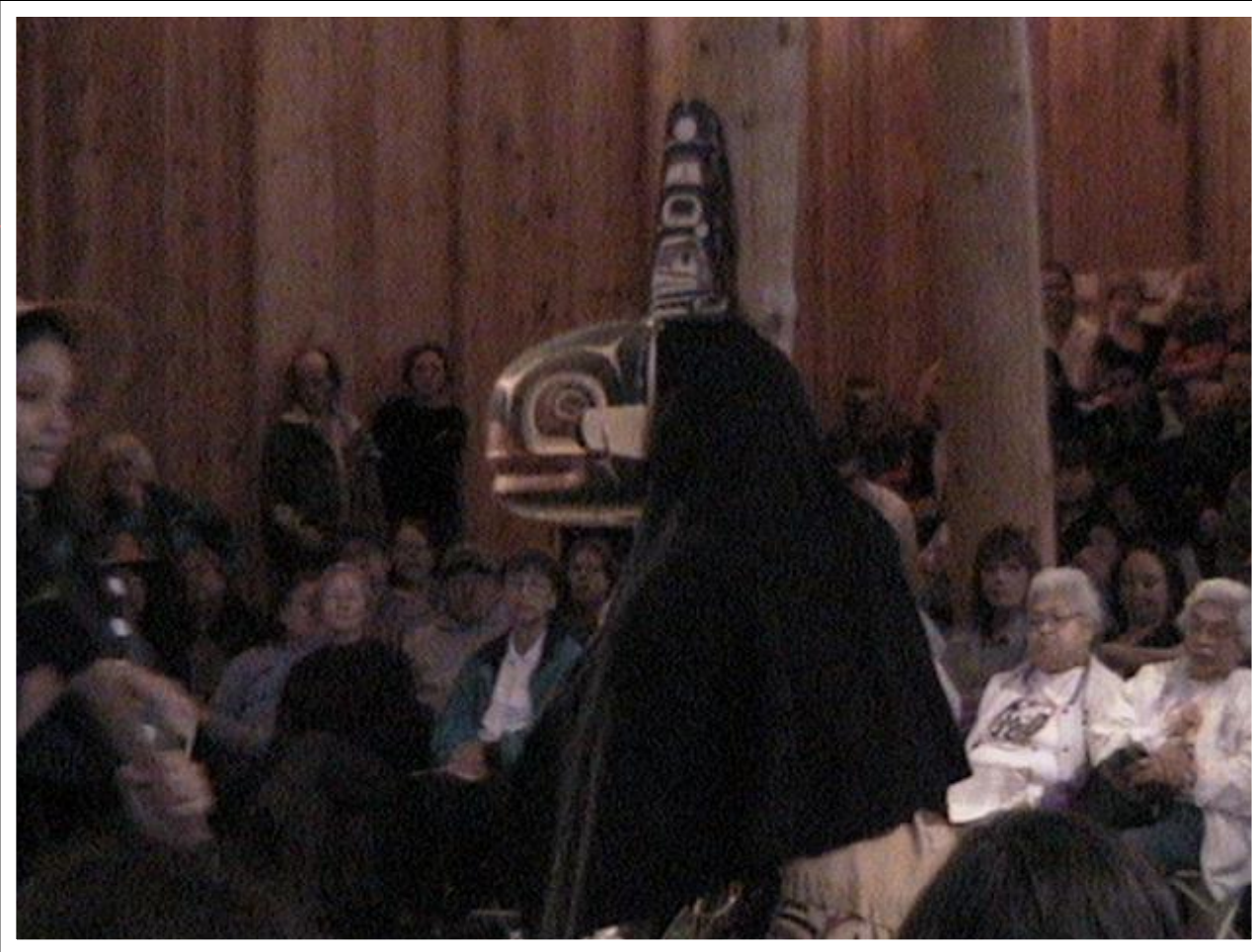

David Boxley



# The Little Boston Harbor Library

---

## Native American Collection

The Little Boston Branch has more than 700 books in its collection about Native American history, art, and tradition. On display is a copy of the original treaty between the S'Klallam Tribe and the U.S. Government. In addition, gracing the walls are a number of signed prints by a member of the S'Klallam Tribe.



## Award Winning Library

---

The Little Boston Branch received the Excellence in Small &/or Rural Public Library Service Award from the Public Library Association & EBSCO Information Services on for its outstanding service to the community.

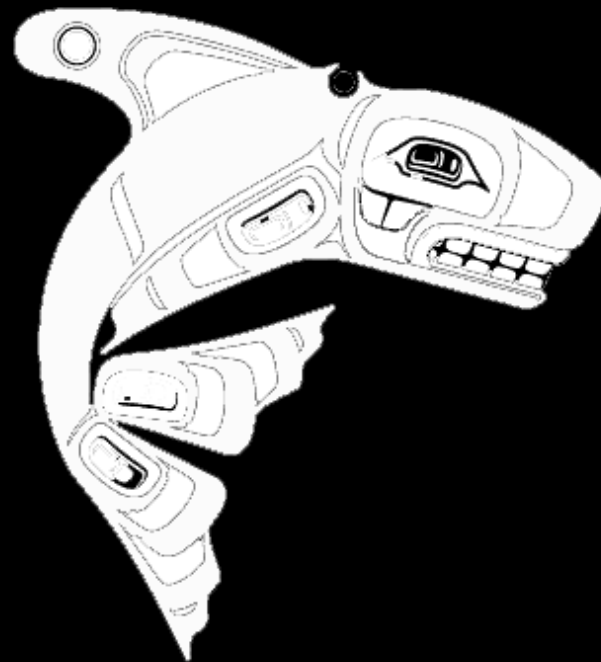

# Suquamish Tribe:

---

- Early Learning Center
- House of Awakened Culture
- Museum
- [www.suquamishmuseum.org](http://www.suquamishmuseum.org)



# Suquamish Early Learning Center



# Facts and Figures

---

- \$19 million campaign over 5.5 years
- \$7 million raised from non-tribal sources
- Learning Center, \$4.8 million
- Longhouse, 12,000 square feet, \$8 million
- Museum, 9000 square feet, \$6.5 million
- Longhouse and Museum-Mithun Architects



# Keys to Success

---

- Strong Support from the Tribal Chairman and Council
- Broad and strong support from the community
- The Suquamish Foundation
- Tour of Funders in advance of the campaign
- Strong Seattle support
- Signature Special Events

# Longhouse



# Museum



MASH MUSEUM - MAIN GALLERY SPACE

# What Are the Commonalities?

VISION OF THE ELDERS AND THEIR SUPPORT

CAPACITY BUILDING FOR THE SPONSORING ORGANIZATION FIRST!

CLEAR ARTICULATION OF THE PROJECT

CAREFUL AND THOUGHTFUL FUNDER RESEARCH

COLLABORATIVE, COMPETITIVE APPLICATIONS

MULTIPLICITY OF FUNDING SOURCES

# Commonalities (Cont'd)

---



**INNOVATIVE SPECIAL  
EVENTS**



**BROAD AND STRONG  
COMMUNITY SUPPORT**



**EMPOWERING TRIBAL  
MEMBERS AND OTHERS**

# Funding for programs and projects

---

Private and public grants

Government, grants, contracts and earmarks

Individual giving

Annual funds

Special events

Earned income



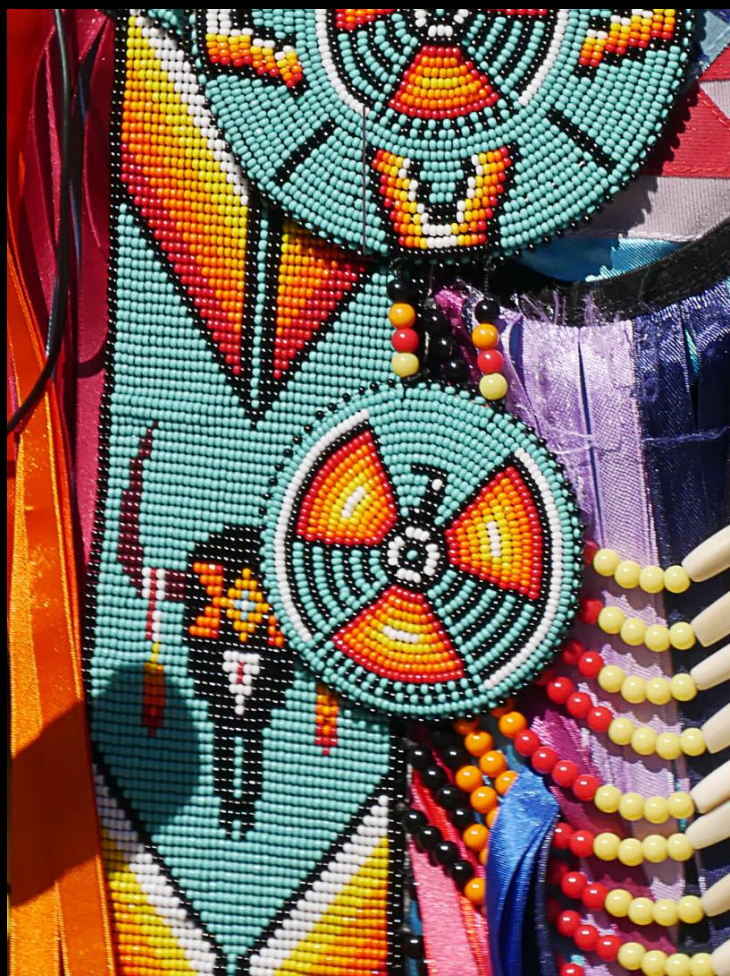

# Culture Builds Communities

Thank you for watching this tutorial. If you have questions, please email [president@atalm.org](mailto:president@atalm.org).

To view helpful resources, visit [www.atalm.org](http://www.atalm.org)