



Culture Builds Communities

A project of the Association of Tribal Archives,
Libraries and Museums

funded by the

Institute of Museum and Library Services
and the
National Museum of the American Indian

CULTURE BUILDS COMMUNITIES

Design Webinar Series

1. The Design Process
2. Selecting and Working with Architects and Contractors
3. **Connecting Your Programming Needs With Your Building**
4. Site Selection, Analysis, & Design
5. Developing the Design – Indigenous Architecture
6. Developing the Design – The Contemporary Museum



Dee Rendon AIA, LEED AP BD+C
Senior Architect
Valhalla Engineering
Denver, CO



Shawn Evans, AIA
Principal
Atkin Olshin Schade Architects
Santa Fe, NM



Samuel Olbekson, AIA, NCARB, AICAE
Principal
Cunningham Group Architecture, Inc.
Minneapolis, MN

Shawn Evans, AIA. Shawn, who has been a part of ATALM training programs since 2013, is Principal of Atkin Olshin Schade Architects, a 27-person architecture firm in Santa Fe and Philadelphia. In addition to leading both architectural and planning projects, Shawn is Director of Preservation and Cultural projects. He has received training in the planning and design of collections environments and has overseen projects for the Department of the Interior Museum, Penn Museum, Wesleyan University Museum, the UNM Natural History Science Center, the Ohkay Owingeh Museum, and the Palace of the Governors. He has taught architectural design and historic preservation at the UNM, Temple, and Penn. He has spoken at numerous regional and national preservation, tribal and museum conferences. He is a James Marston Fitch Fellow, through which he collaborated with Pueblo tribes on a study of their contemporary preservation practices. His tribal projects include collaborations with Ohkay Owingeh, Isleta, Kewa, Zuni, Cochiti, Picuris, Mescalero Apache, and the Chippewa Cree.



Shawn Evans, AIA

Principal

Atkin Olshin Schade Architects (AOS)

Santa Fe, NM / Philadelphia, PA

Design Webinar Series

3. Connecting Your Programming Needs With Your Building

Presented by: **Shawn Evans, AIA**
AOS Architects
Santa Fe, NM
sevans@aosarchitects.com



FOR SUPPORTING DOCUMENTS, VISIT
[HTTP://WWW.ATALM.ORG/NODE/440](http://www.atalm.org/node/440)

AGENDA

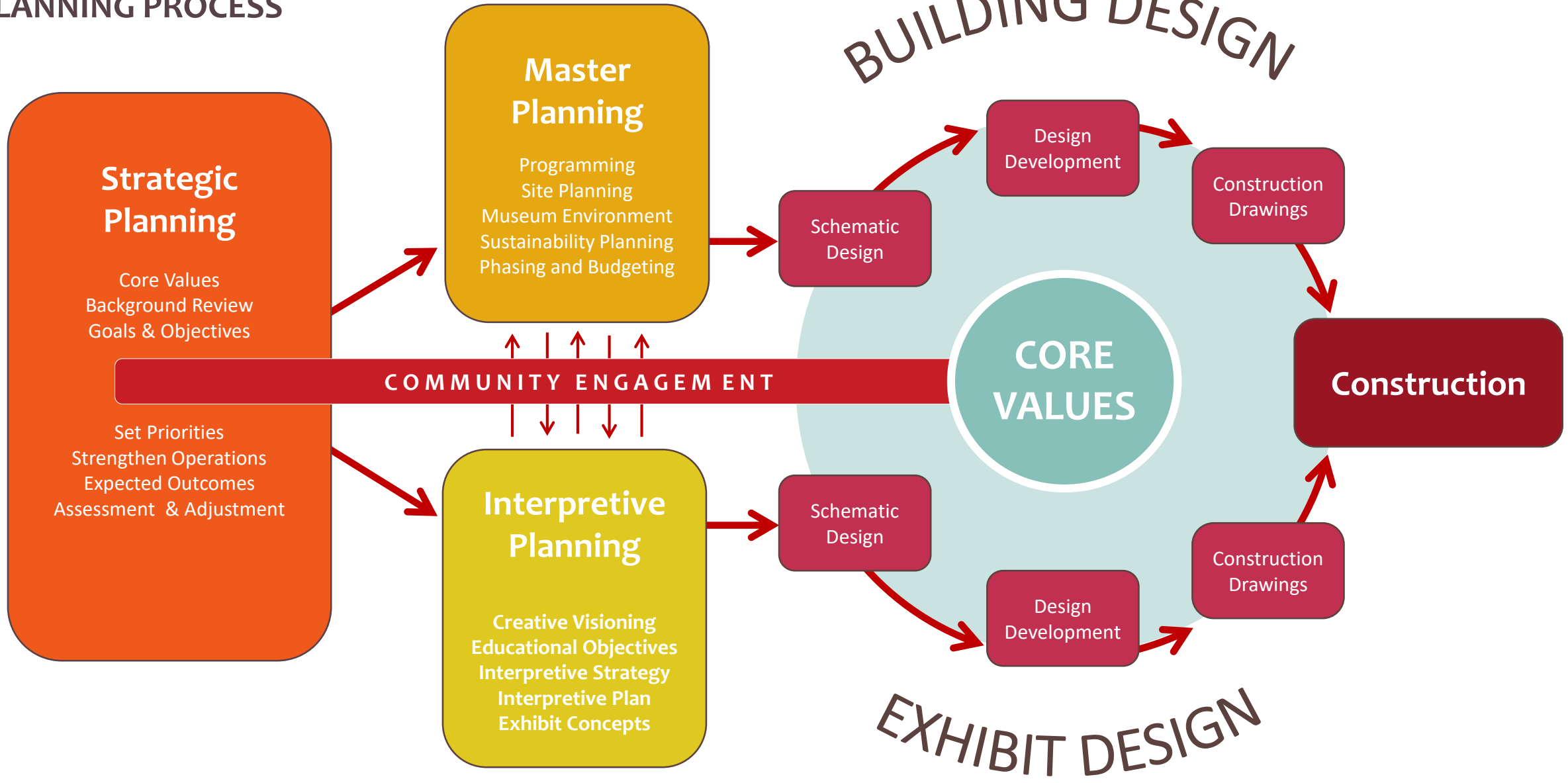
3. Connecting Your Programming Needs With Your Building

- a. Planning Process
- b. Interpretive Planning
- c. Spaces for Collections
- d. The Space Program
- e. Back to the Center
- f. Case Study
- g. Prototyping



FOR SUPPORTING DOCUMENTS, VISIT
[HTTP://WWW.ATALM.ORG/NODE/440](http://www.atalm.org/node/440)

PLANNING PROCESS



INTERPRETIVE PLANNING



Image source: <https://americanindian.si.edu/>

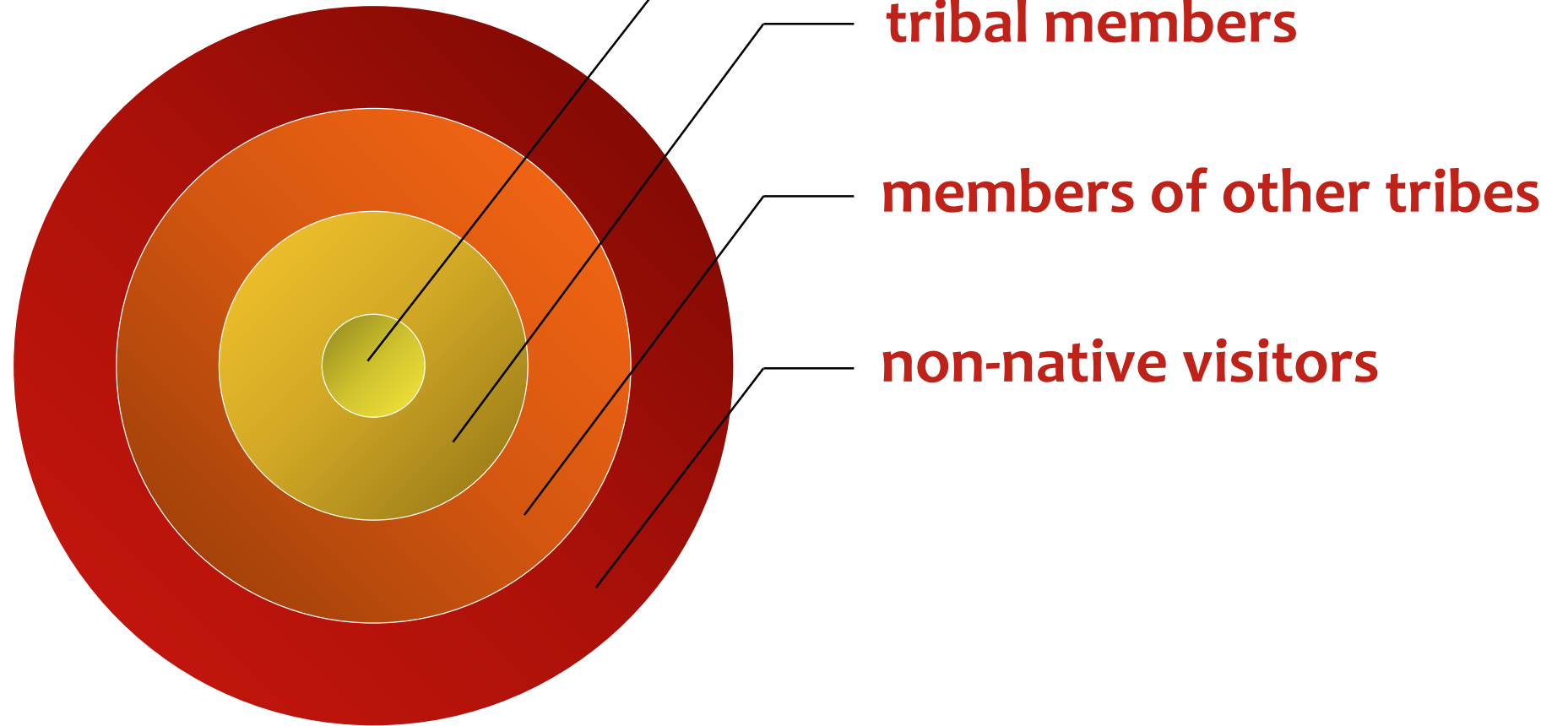
INTERPRETIVE PLANNING

Process

- Significance of the museum: **Why** should people visit?
- Interpretive themes: **What** will visitors learn?
- Audience: **Who** are the targets?
- Location: **Where** will themes be interpreted?
- Media: **What tools** will work best?
- Evaluation: **How** will effectiveness be measured?
- Priorities: **How** will the plan be implemented?

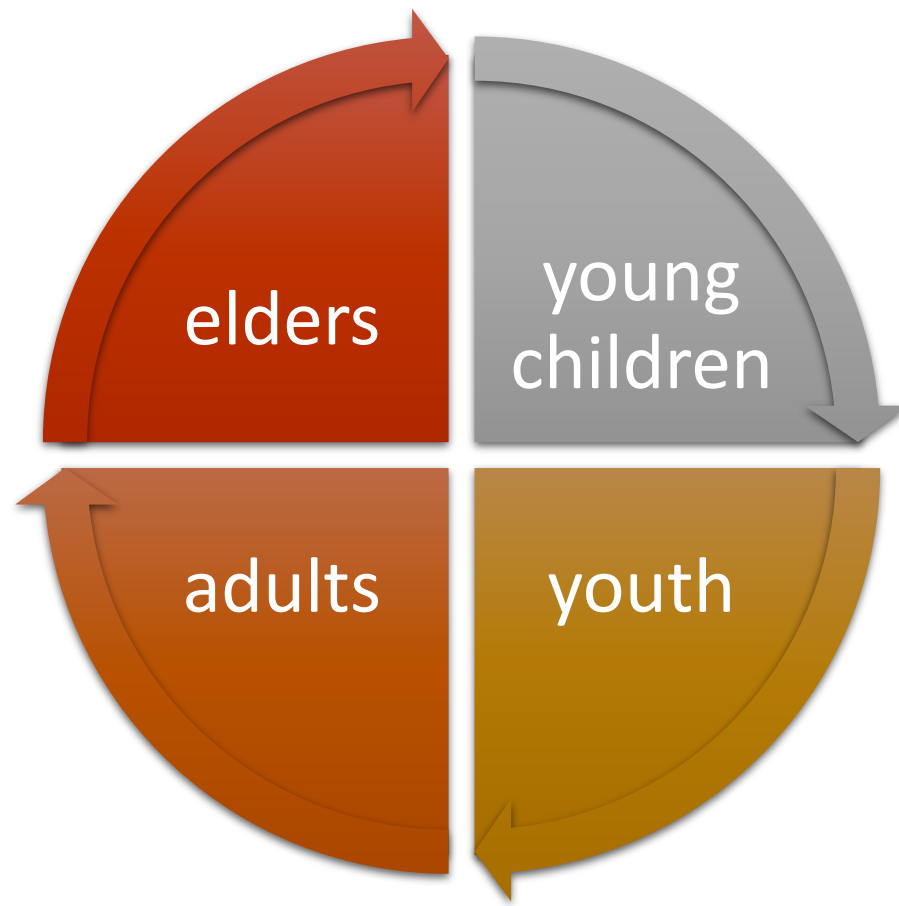
INTERPRETIVE PLANNING

Levels of Access

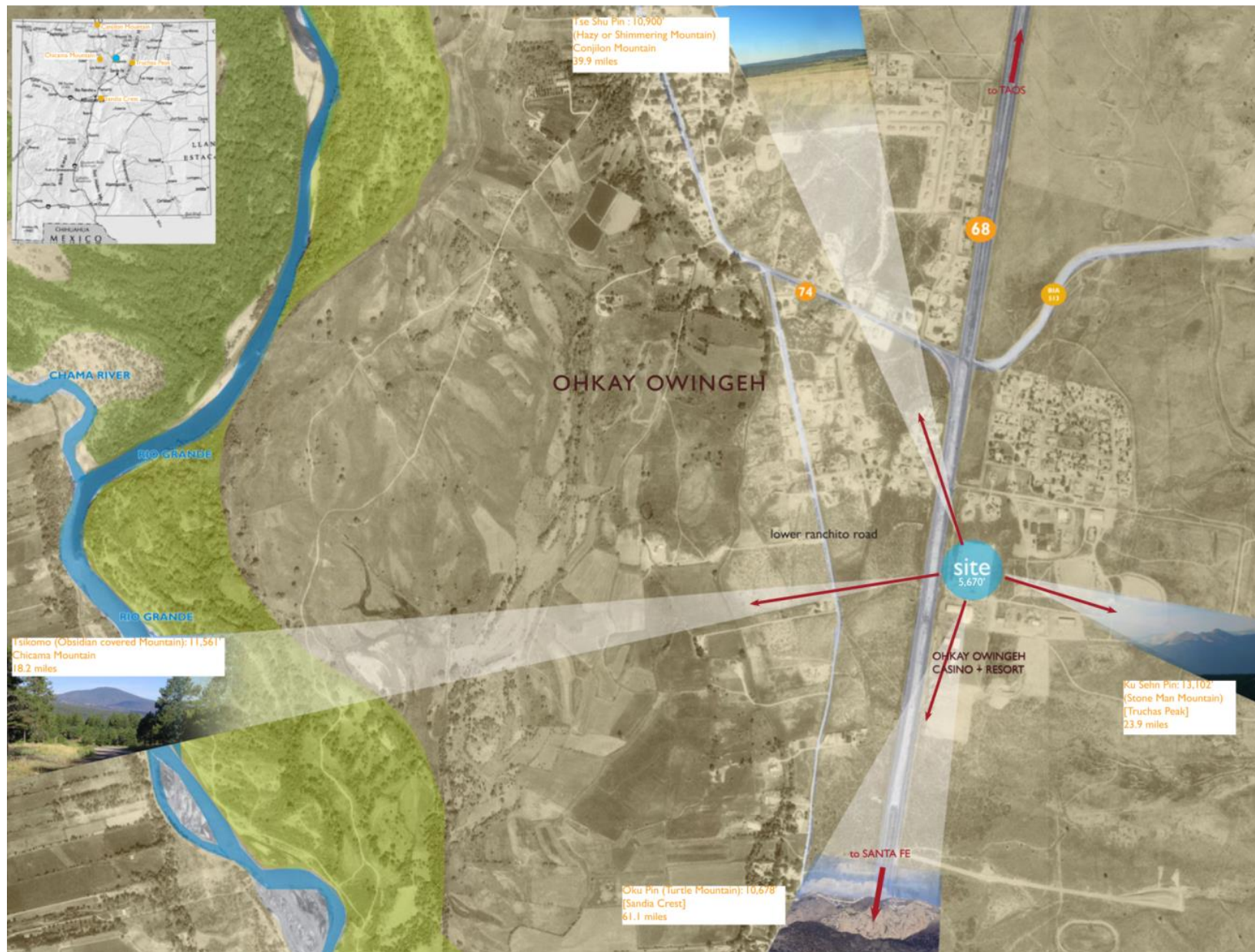


INTERPRETIVE PLANNING

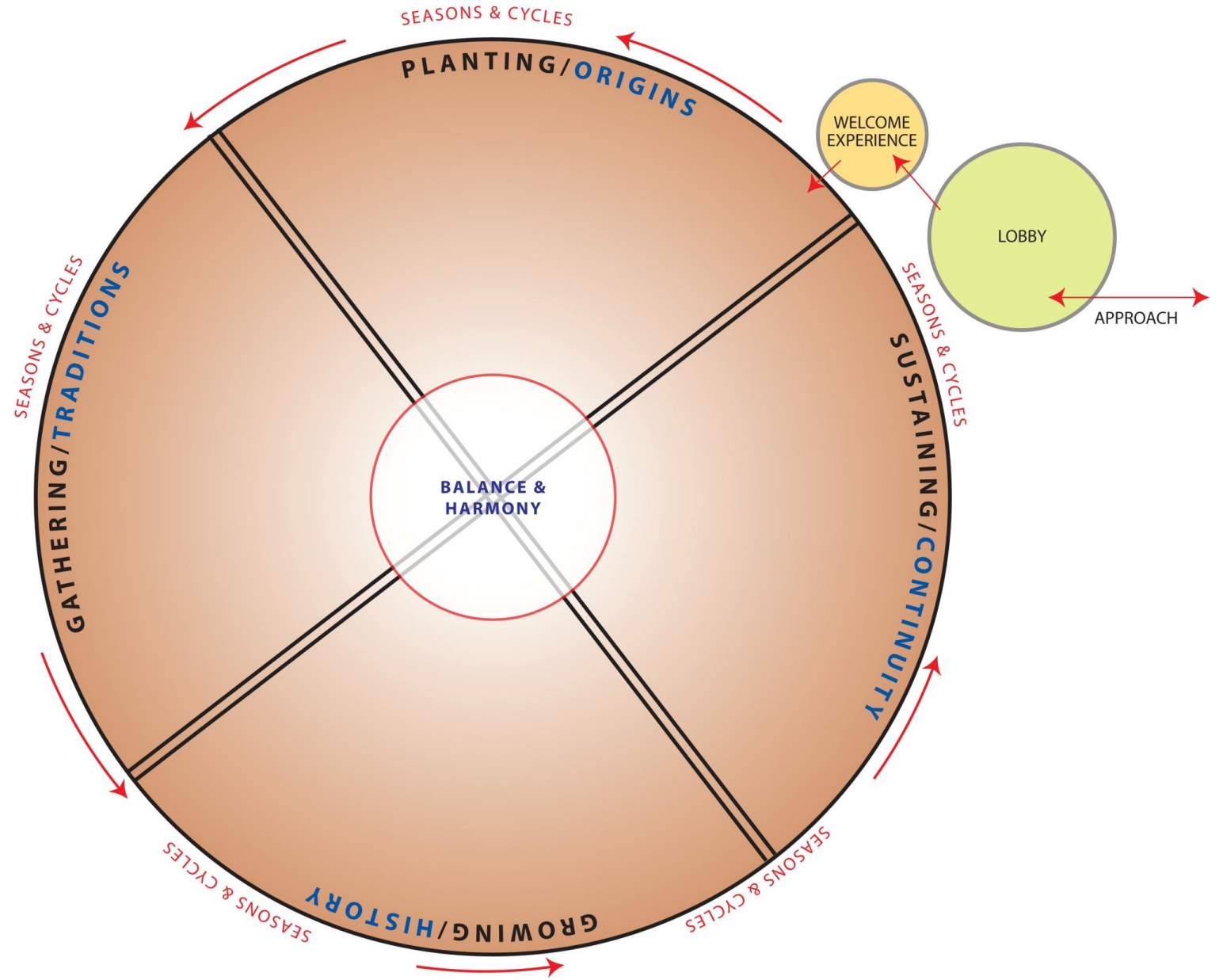
Intergenerational Focus



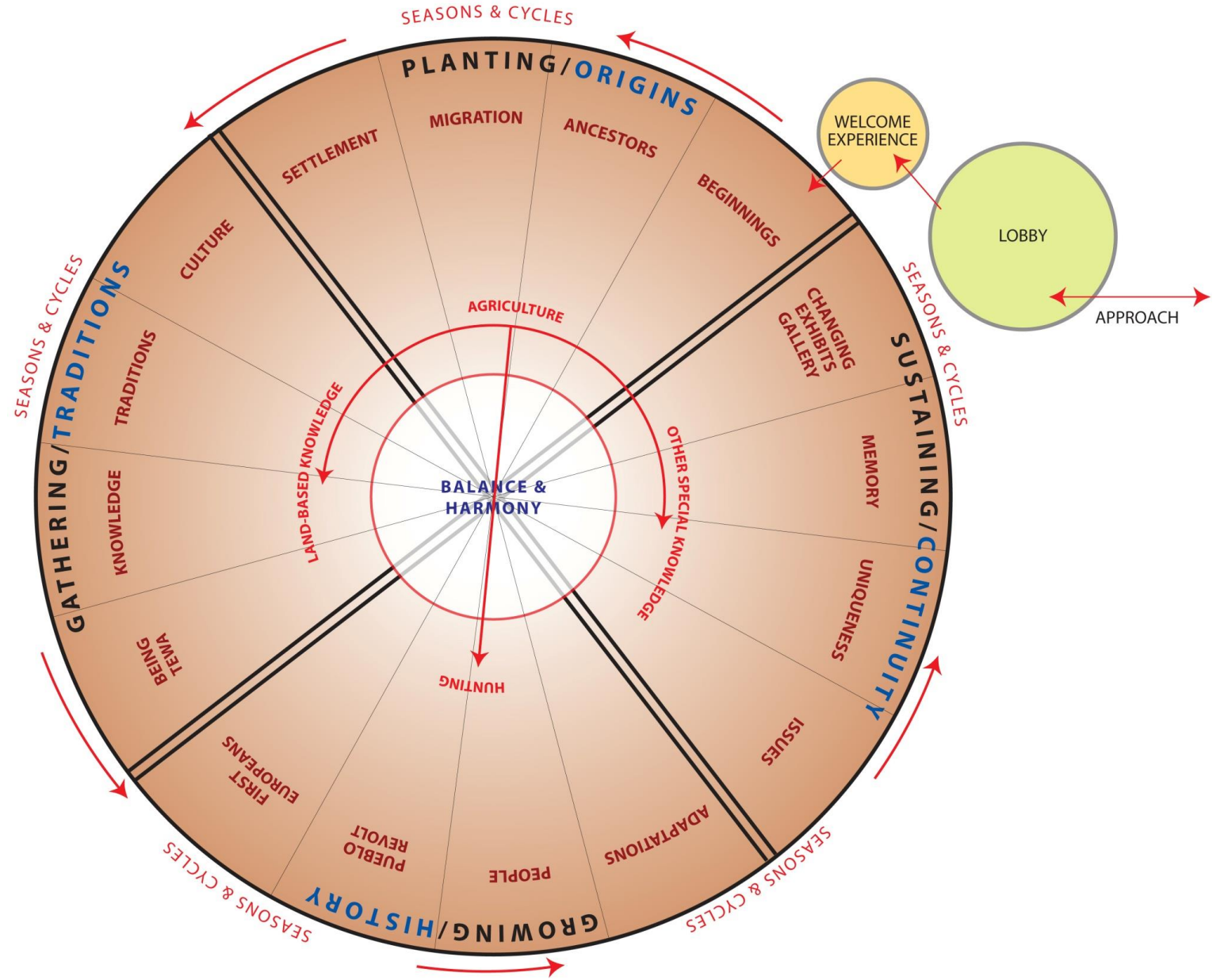
INTERPRETIVE PLANNING Place



INTERPRETIVE PLANNING Themes



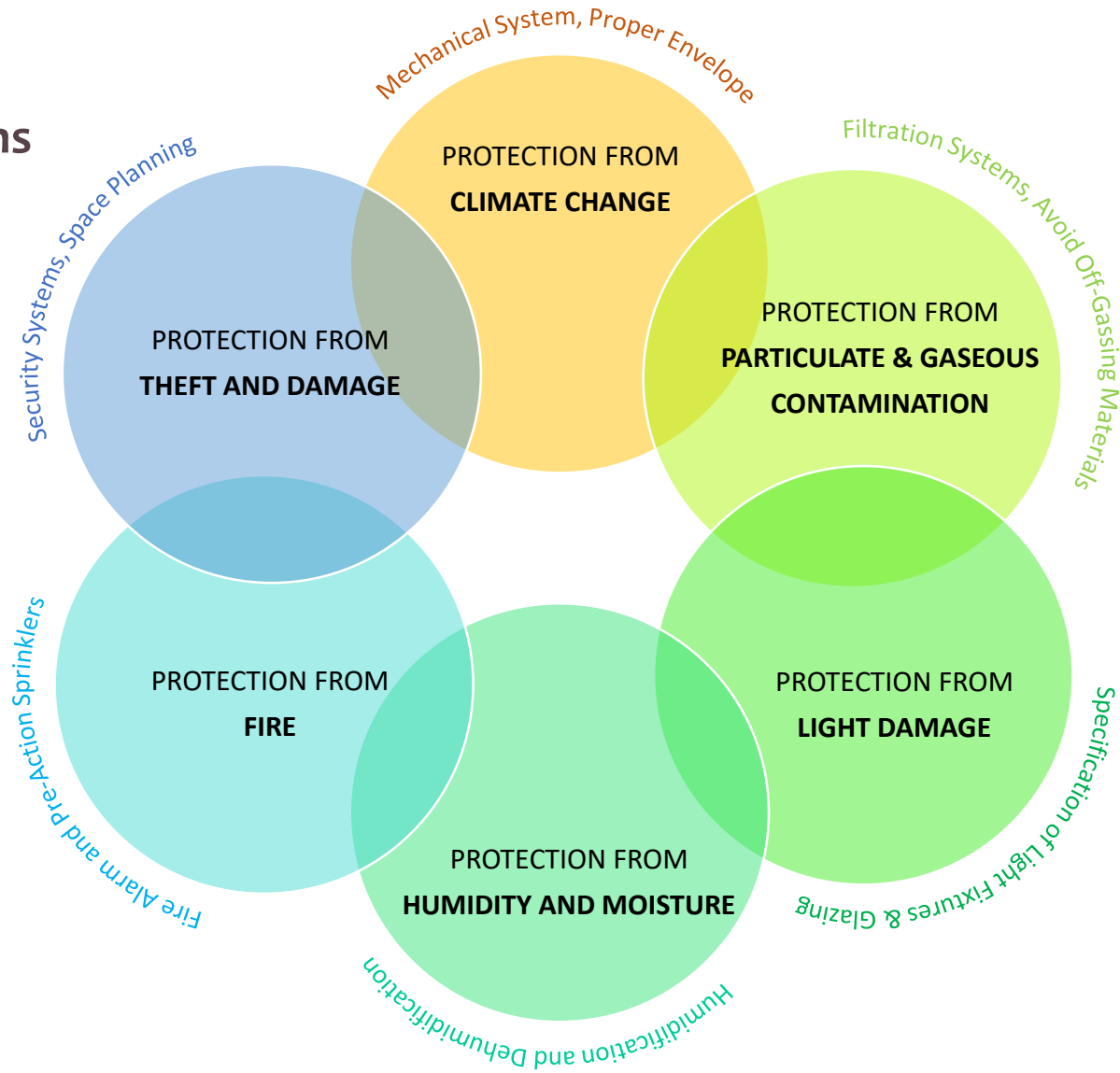
INTERPRETIVE PLANNING Topics





SPACES FOR COLLECTIONS

Spaces for Collections Protection



Spaces for Collections

Technical Issues

- Collection types / storage needs
- Limit off-gassing materials
- Weight capacity of floor slab
- Mixing of collections
- Temperature/humidity
(May need several set points)
- Light control



Spaces for Collections

Cultural Issues

- Living cultural practice
- Ability/necessity to use
- Problem of sealed/bagged collections
- Views to exterior
- “public” access
- Place for prayer, feeding, or communion with objects

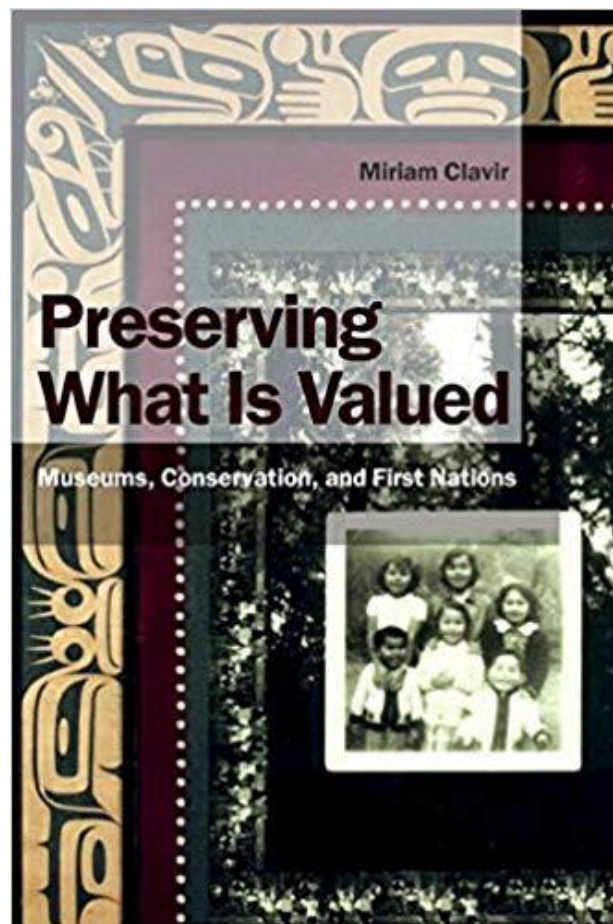


Figure 2

Perspectives on preservation: “Visible” and “invisible” attributes

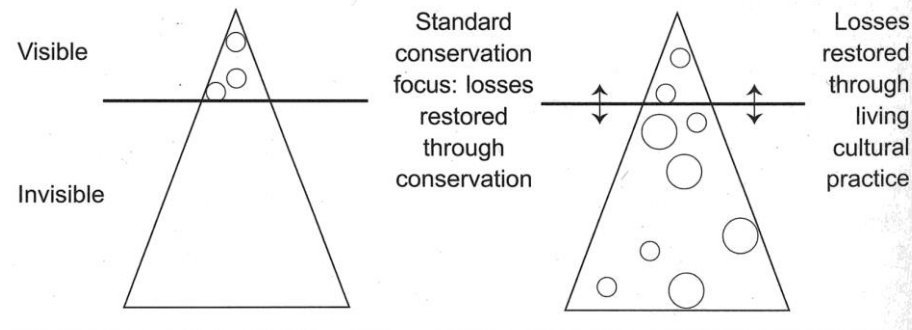
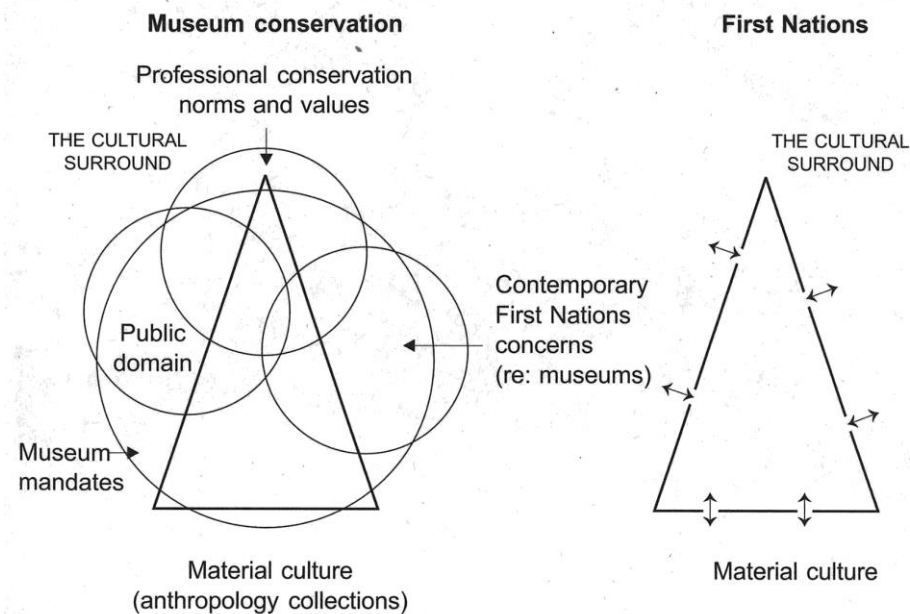
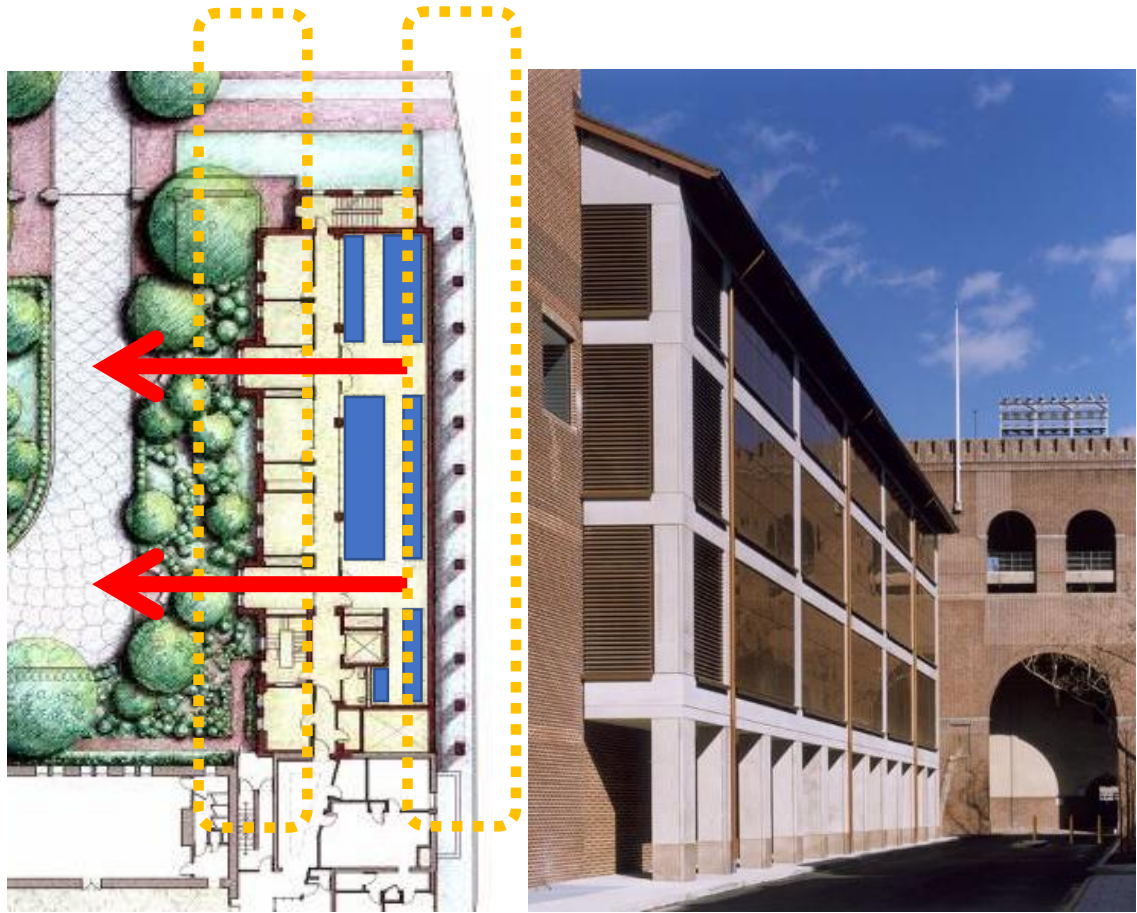


Figure 3

Material culture/collections: Different worlds, different boundaries

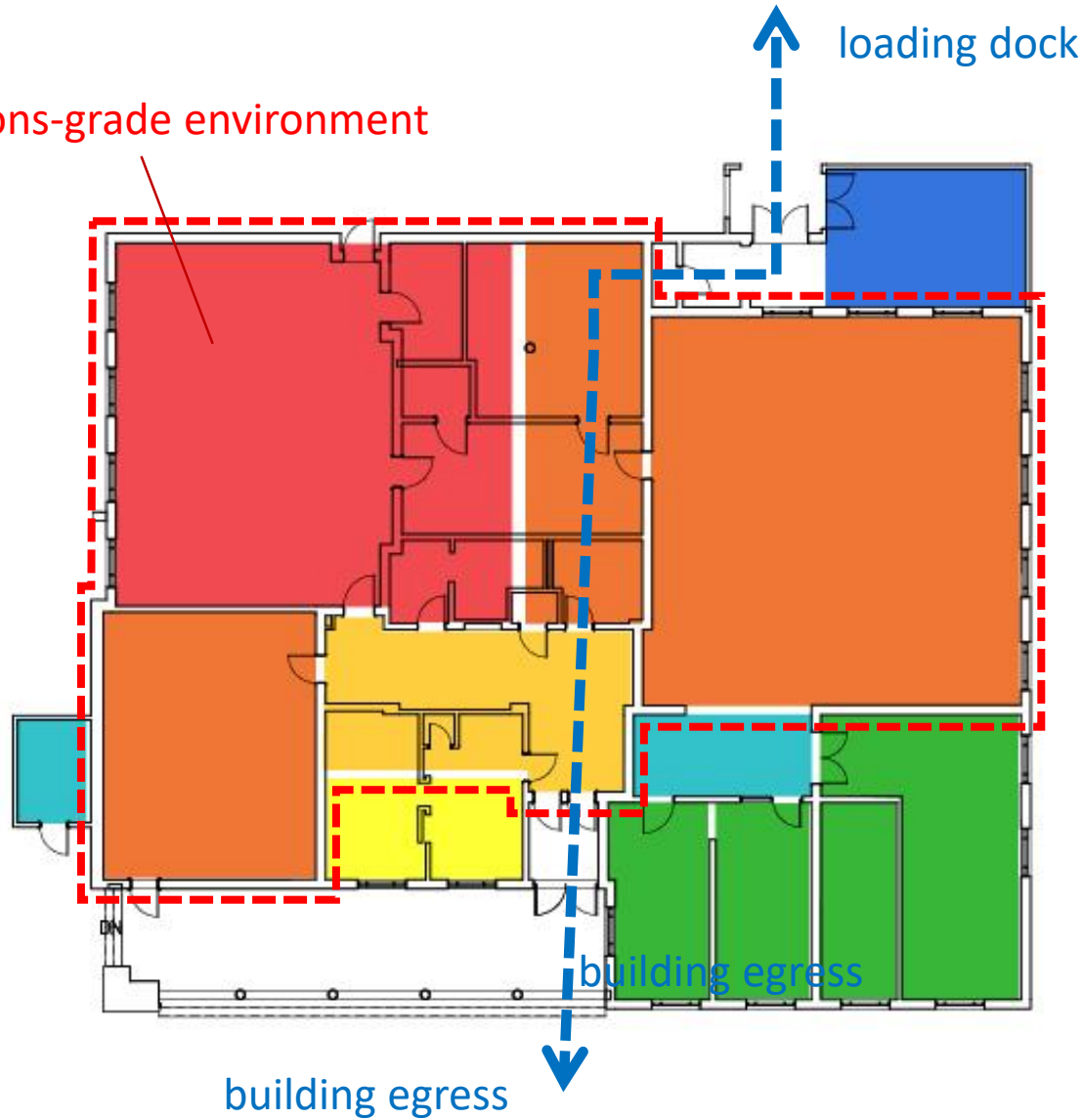


Spaces for Collections Design



Mainwaring Wing, University of Pennsylvania Museum, Philadelphia, PA

collections-grade environment



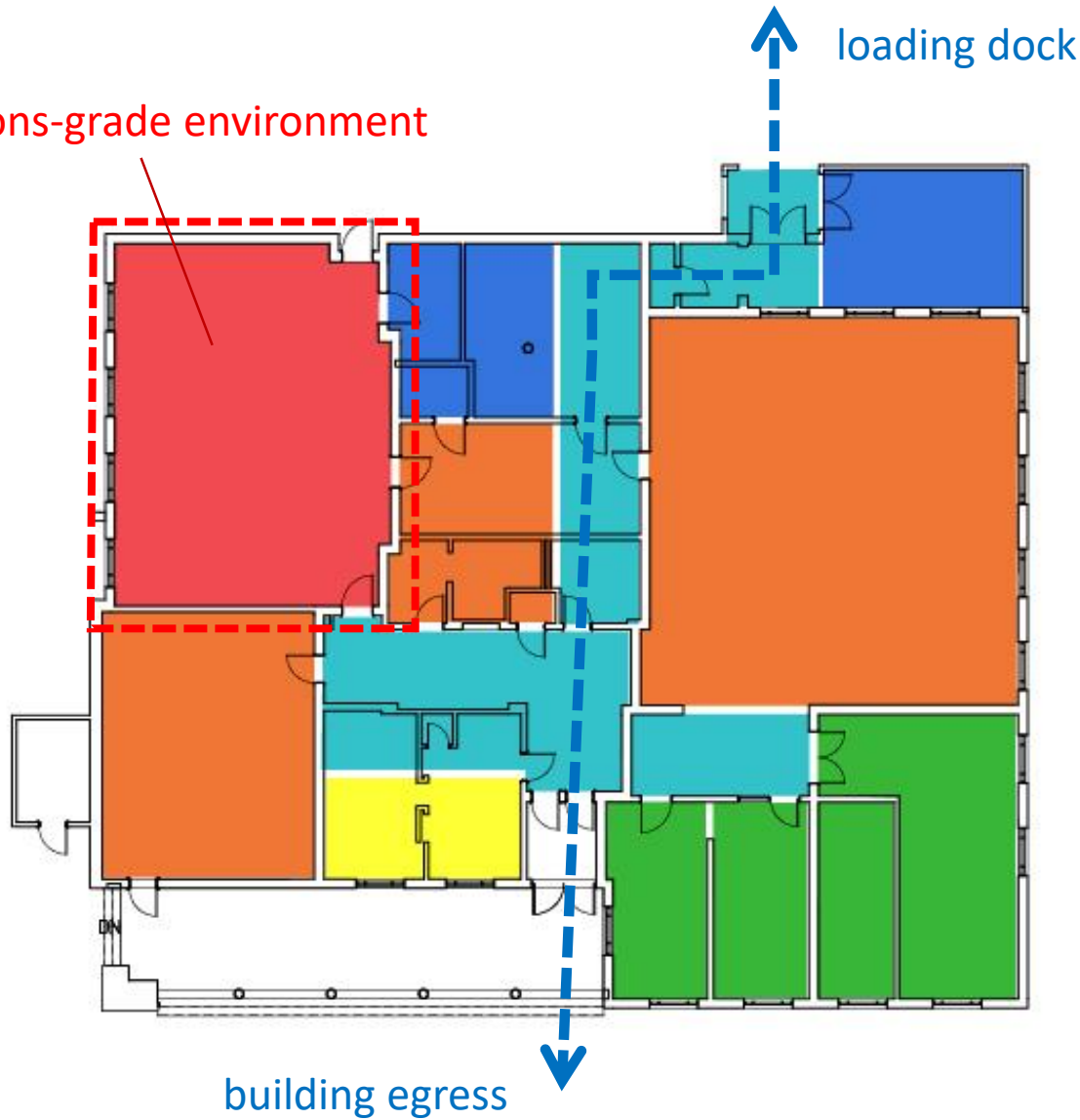
Spaces for Collections Cost Control

PRELIMINARY PLAN - SPACE TYPES

Storage / Mechanical	\$35
Circulation	\$55
Office	\$75
Restrooms	\$125
Museum	\$175
Laboratory	\$175
Collections Storage	\$200

**\$1.11m area-based costs
+ fixed costs**

collections-grade environment



POTENTIAL PLAN - SPACE TYPES

Storage / Mechanical	\$35
Circulation	\$55
Office	\$75
Restrooms	\$125
Museum	\$175
Laboratory	\$175
Collections Storage	\$200

Spaces for Collections Cost Control

**\$930k area-based costs
+ fixed costs**

**16.5% reduction in cost
plus mechanical savings**

Q4. What is the greatest programming challenge for this project? What is your strategy for this phase of the project?

THE SPACE PROGRAM

Image source <https://www.pexels.com/photo/sky-space-dark-galaxy-2150//>

The Space Program

What and How Big?

EXHIBITS

audience – local vs. visitor
audience – anticipated #
audience – school groups
permanent vs. temporary
sequence & duration
audio programming
orientation

COLLECTIONS

current collections
bringing items home
family collections
segregation by materiality
space for nourishment
conservation needs
use needs

CULTURE

language lab
radio station
dance studio
art classrooms
gardens
community kitchen
music and song

The Space Program

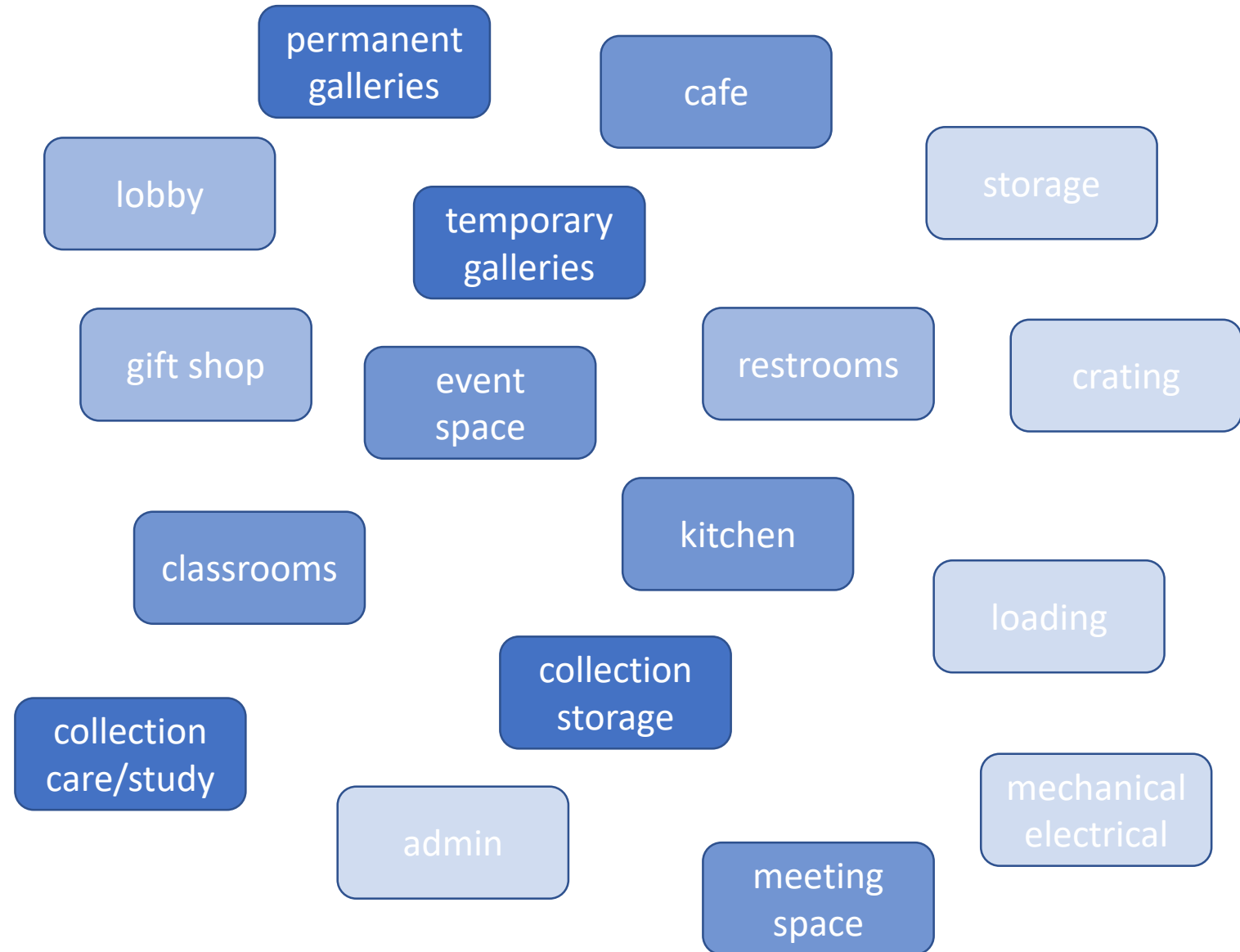
What and How Big?

What is your unique balancing of objects and stories?

How do the past and future come together?

the preservation vs. production of knowledge

The Space Program Needs



The Space Program Sorting

public

lobby

permanent
galleries

cafe

event
space

gift shop

temporary
galleries

restrooms

semi-public

classrooms

meeting
space

admin

kitchen

private

collection
storage

collection
care/study

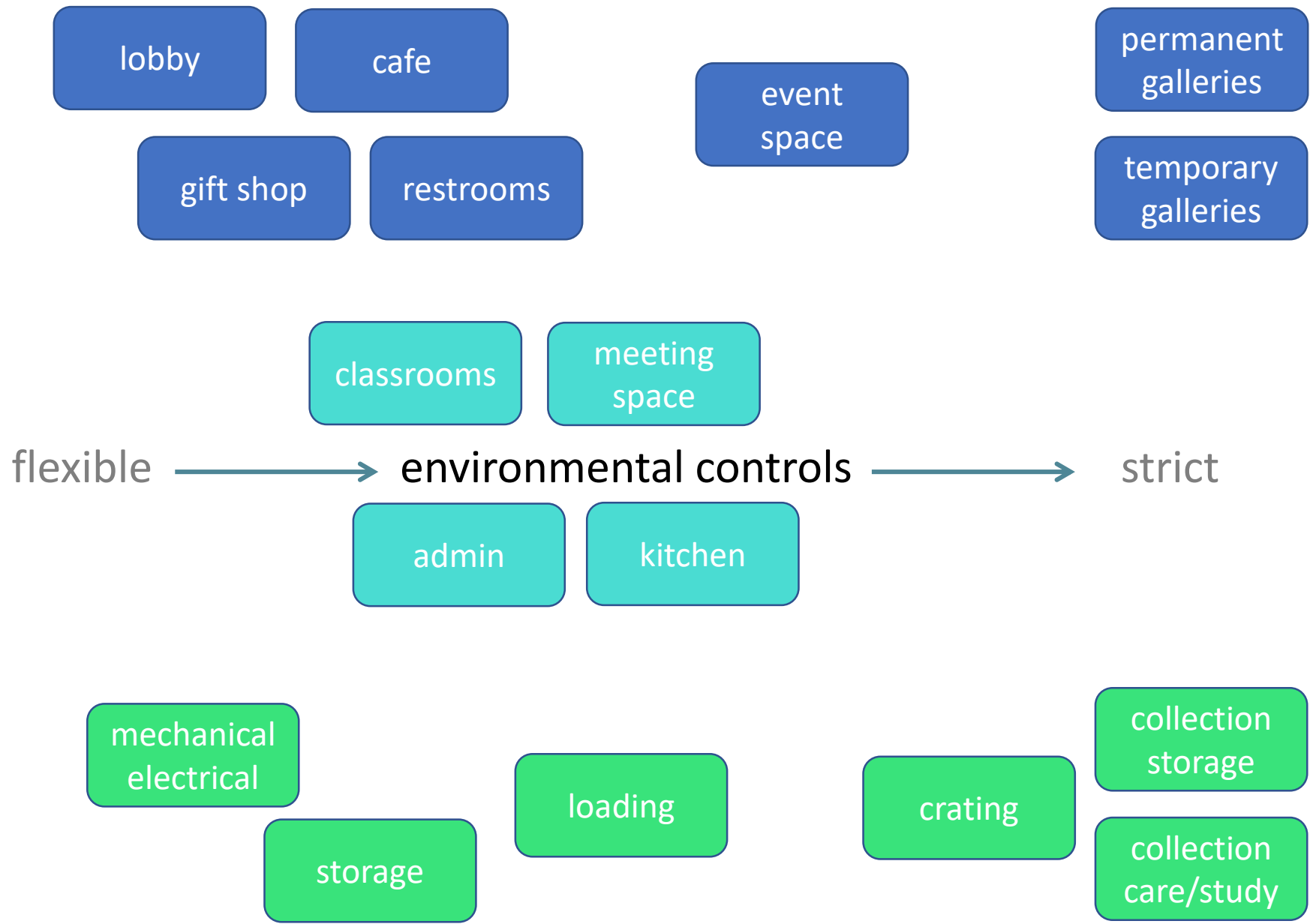
storage

crating

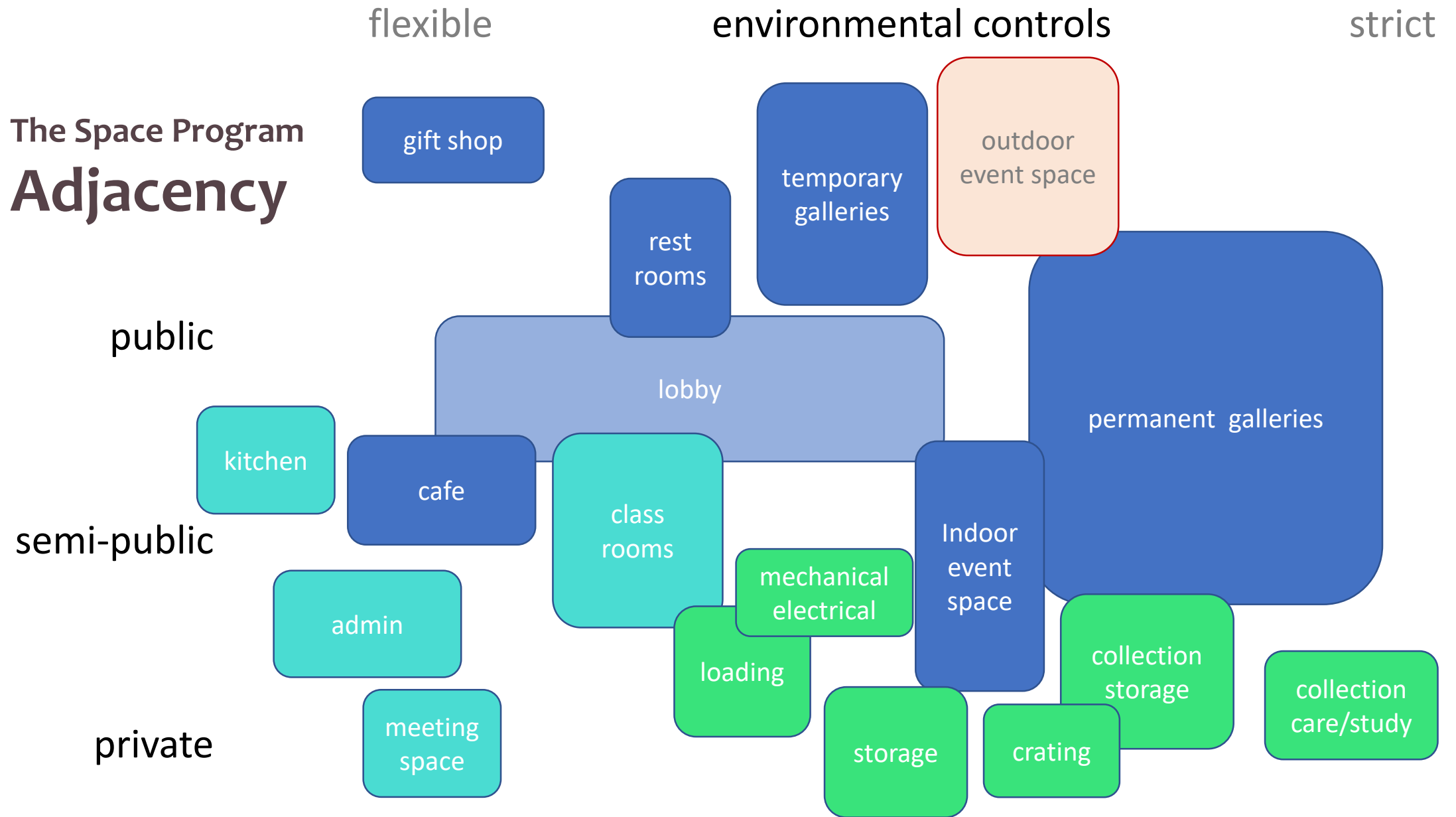
loading

mechanical
electrical

The Space Program Sorting



The Space Program Adjacency



The Space Program Adjacency

flexible

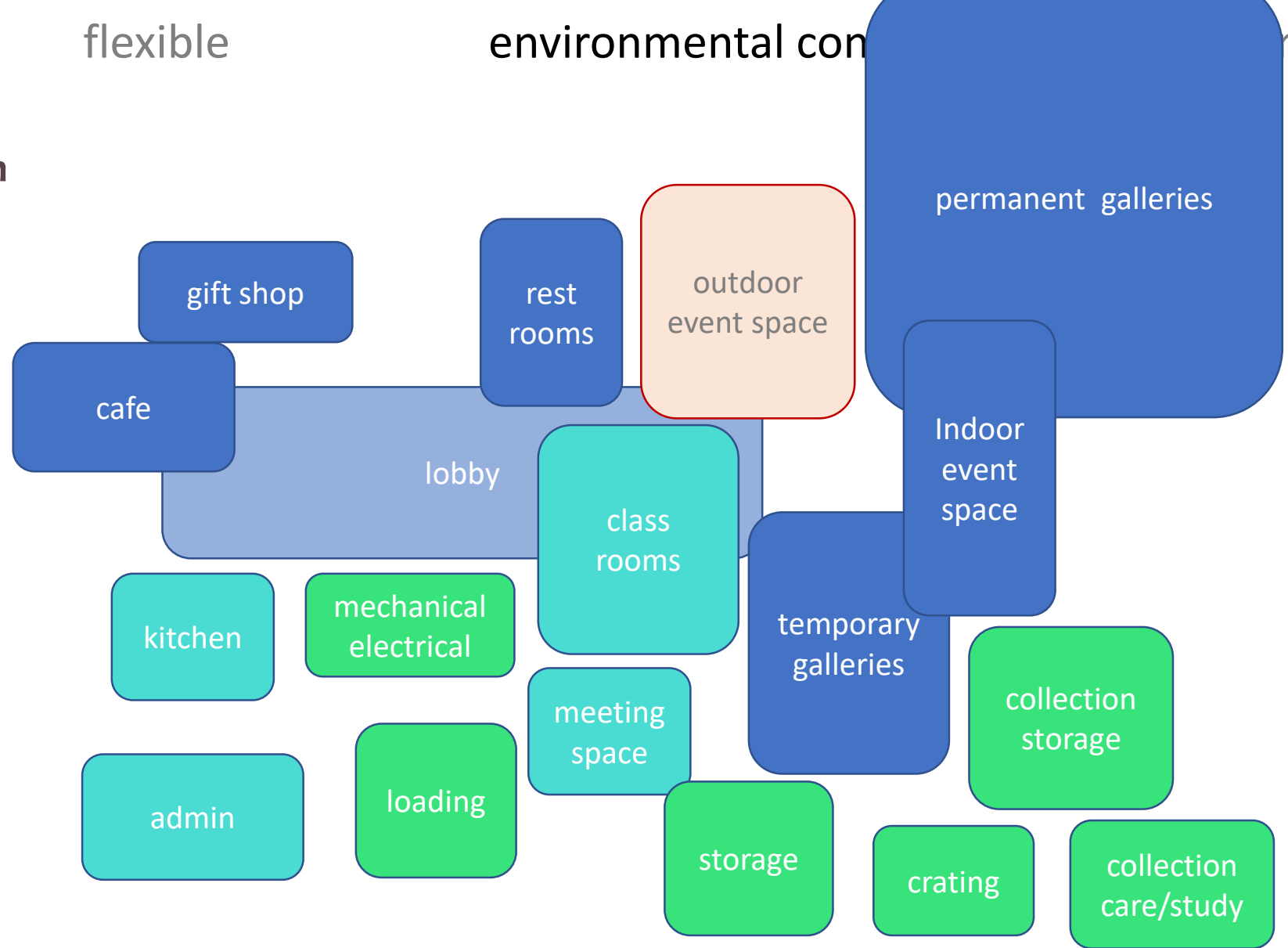
environmental control

strict

public

semi-public

private

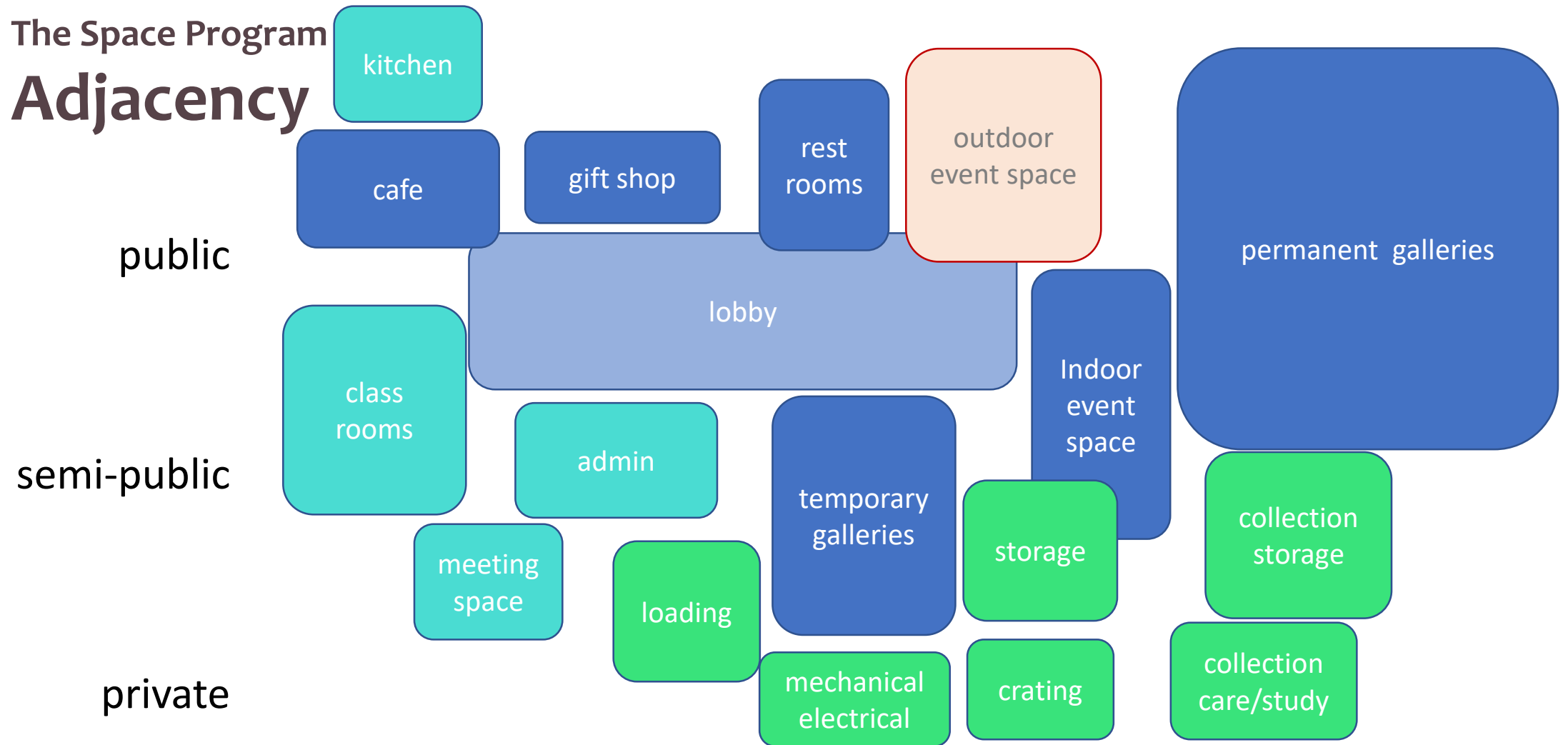


flexible

environmental controls

strict

The Space Program Adjacency



The Space Program Adjacency

flexible

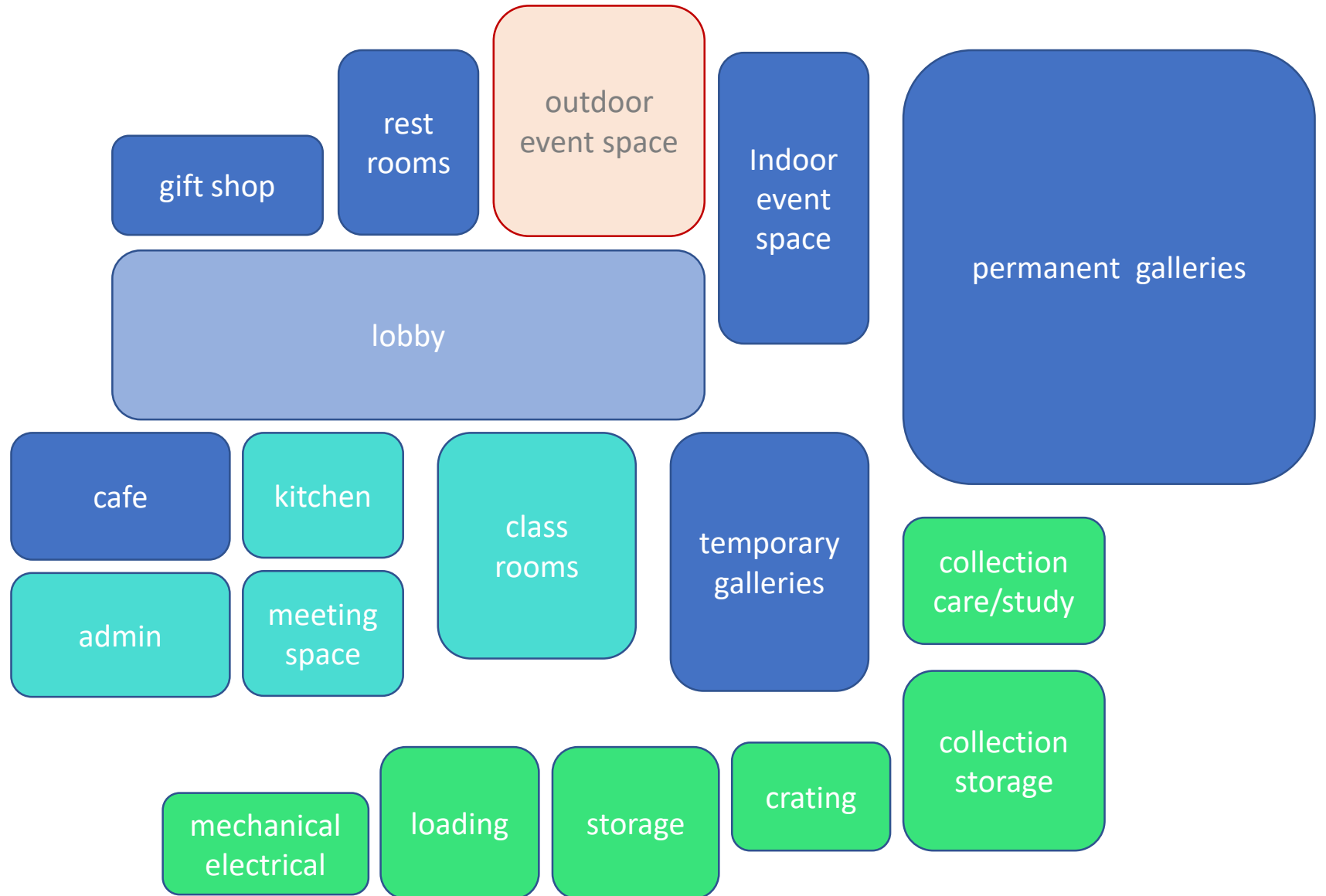
environmental controls

strict

public

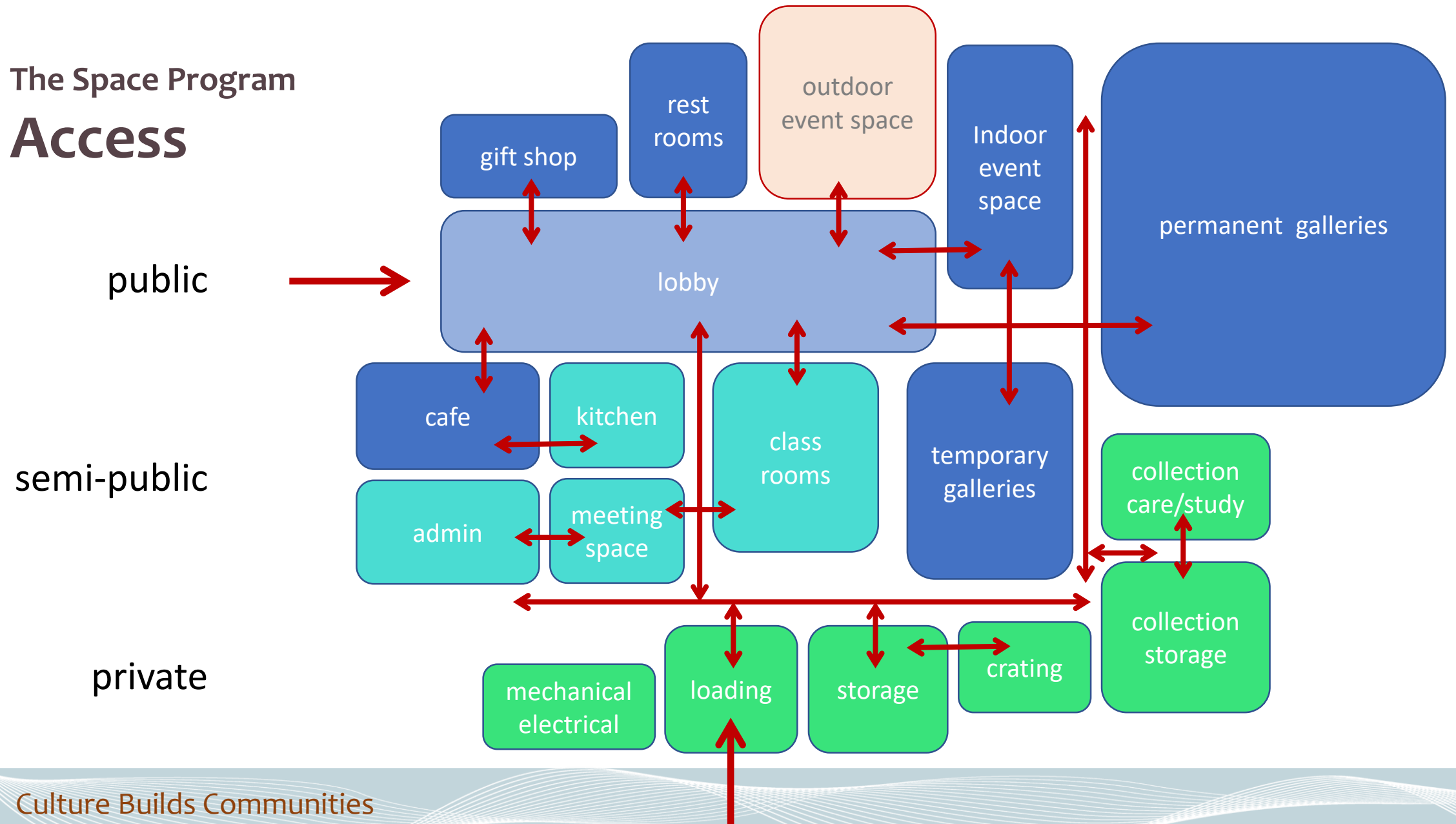
semi-public

private

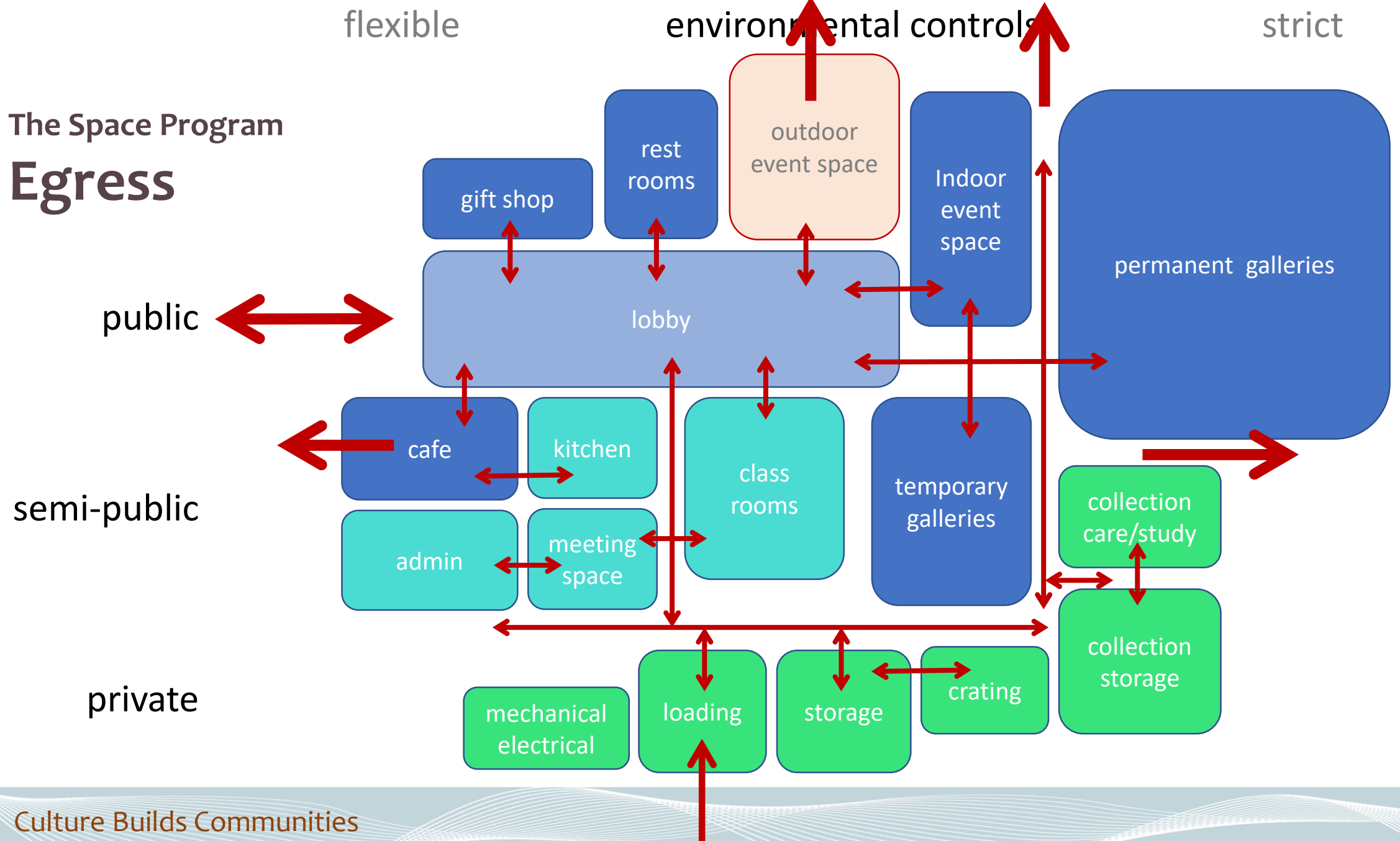


The Space Program Access

flexible environmental controls strict



The Space Program
Egress

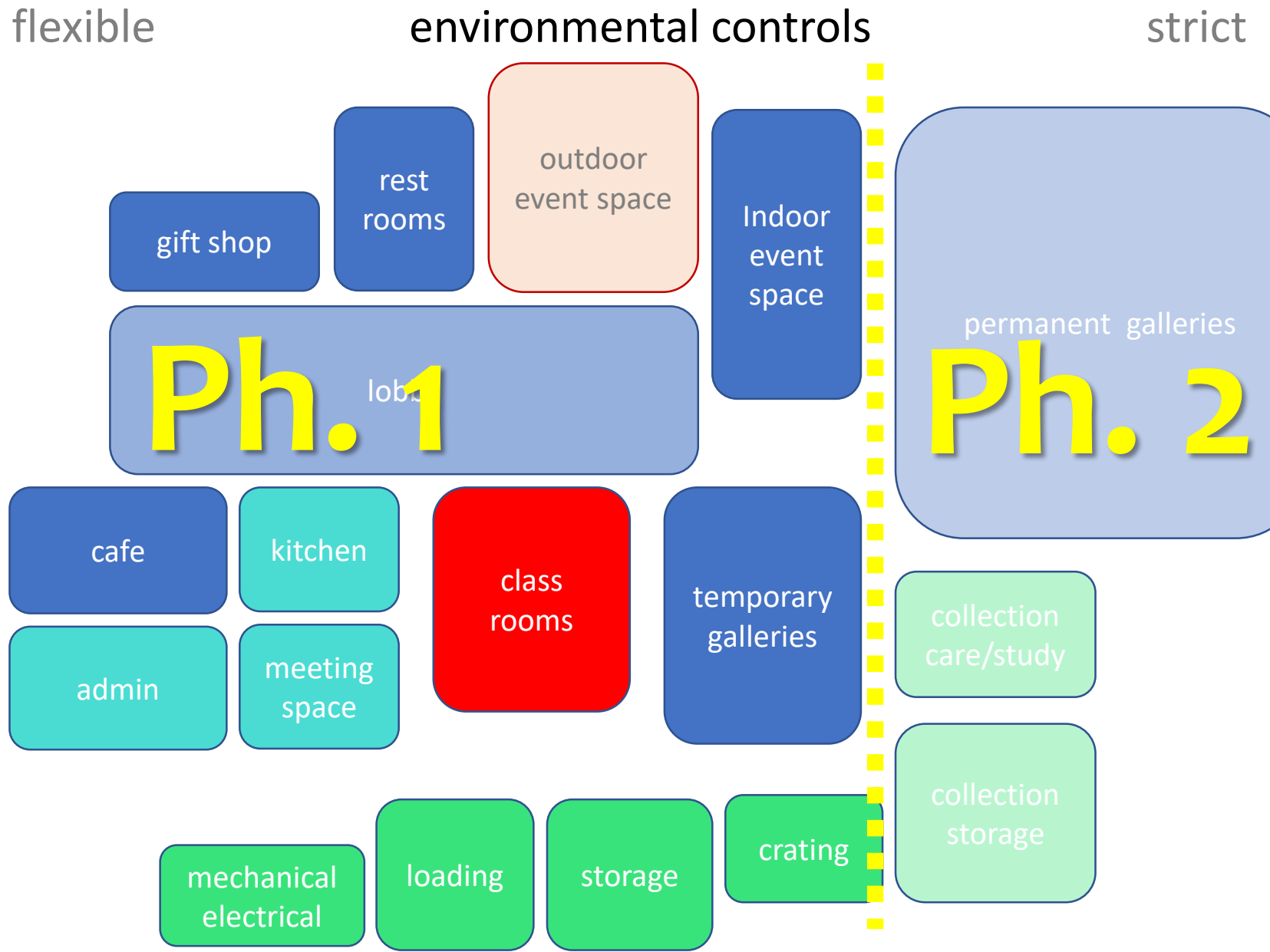


The Space Program

Natural Light



The Space Program Phasing



The Space Program
Security

flexible

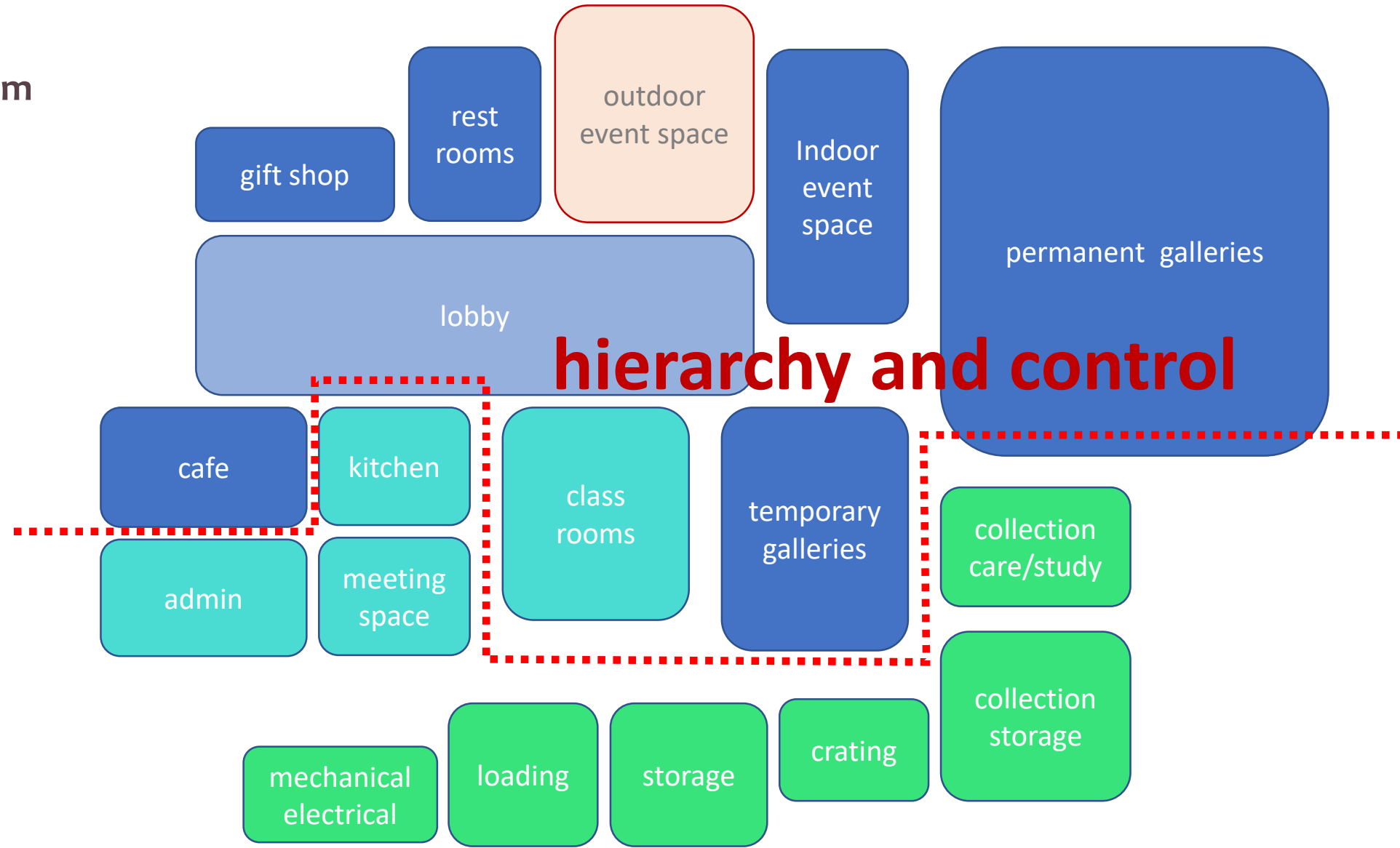
environmental controls

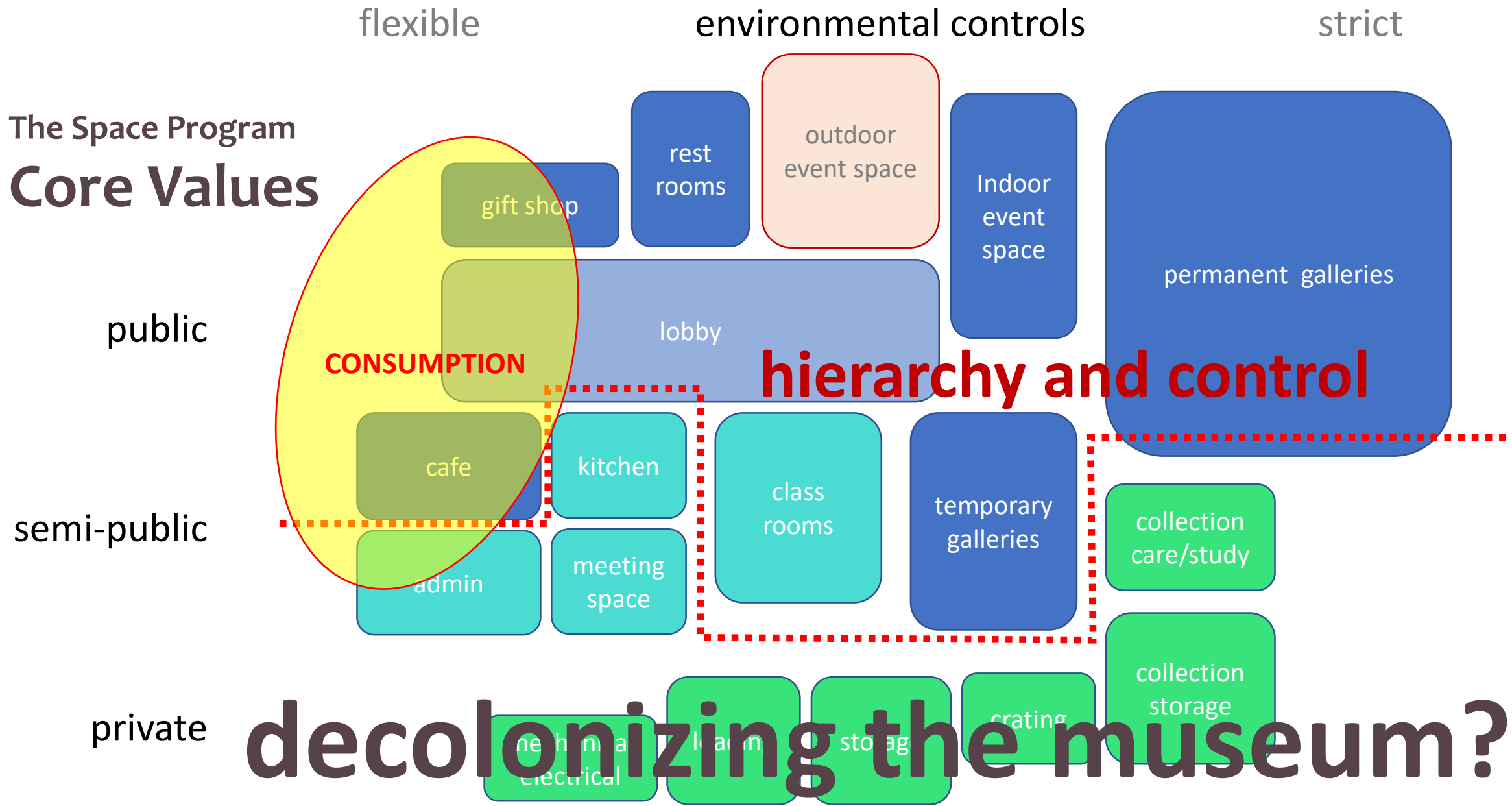
strict

public

semi-public

private



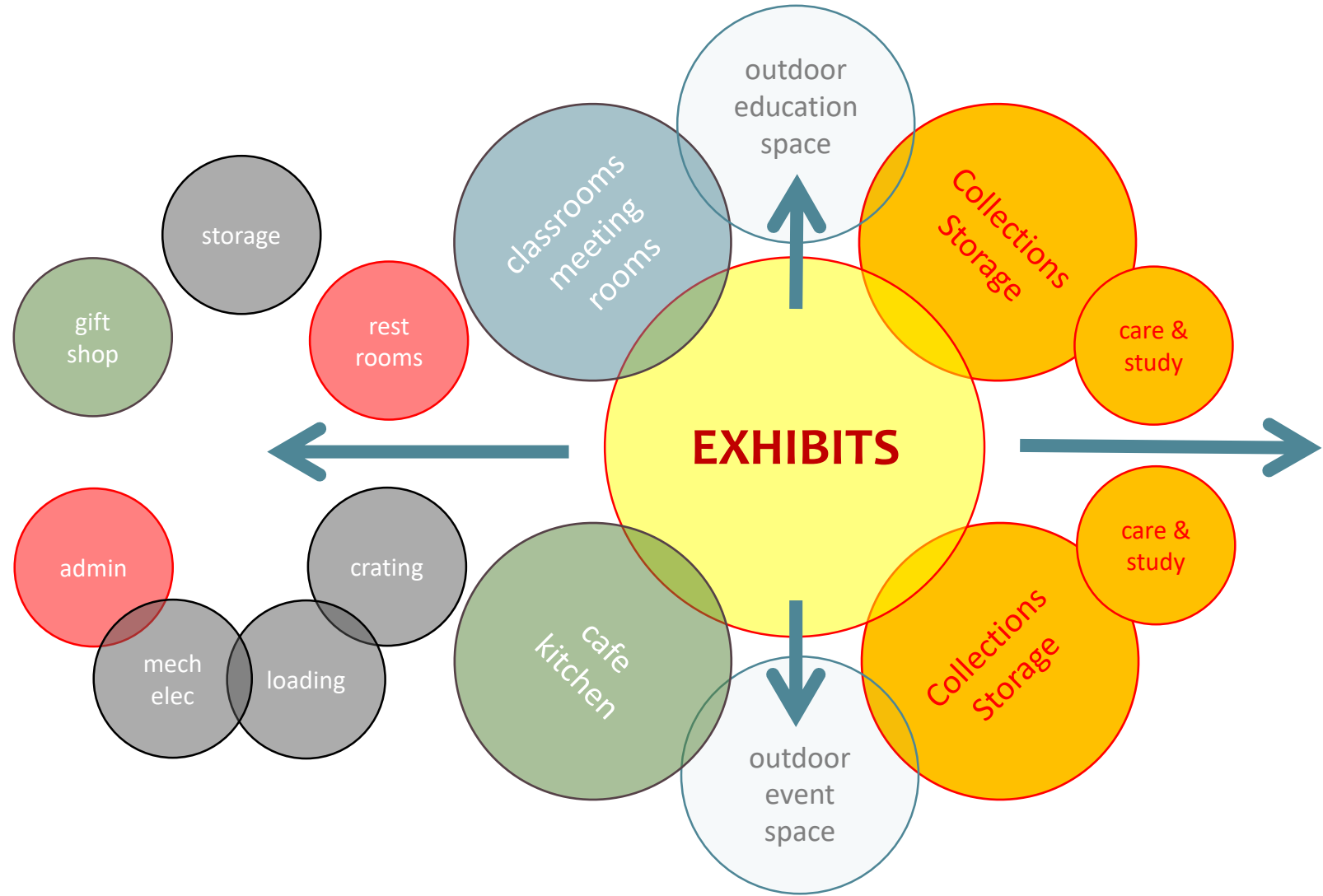


BACK TO THE CENTER

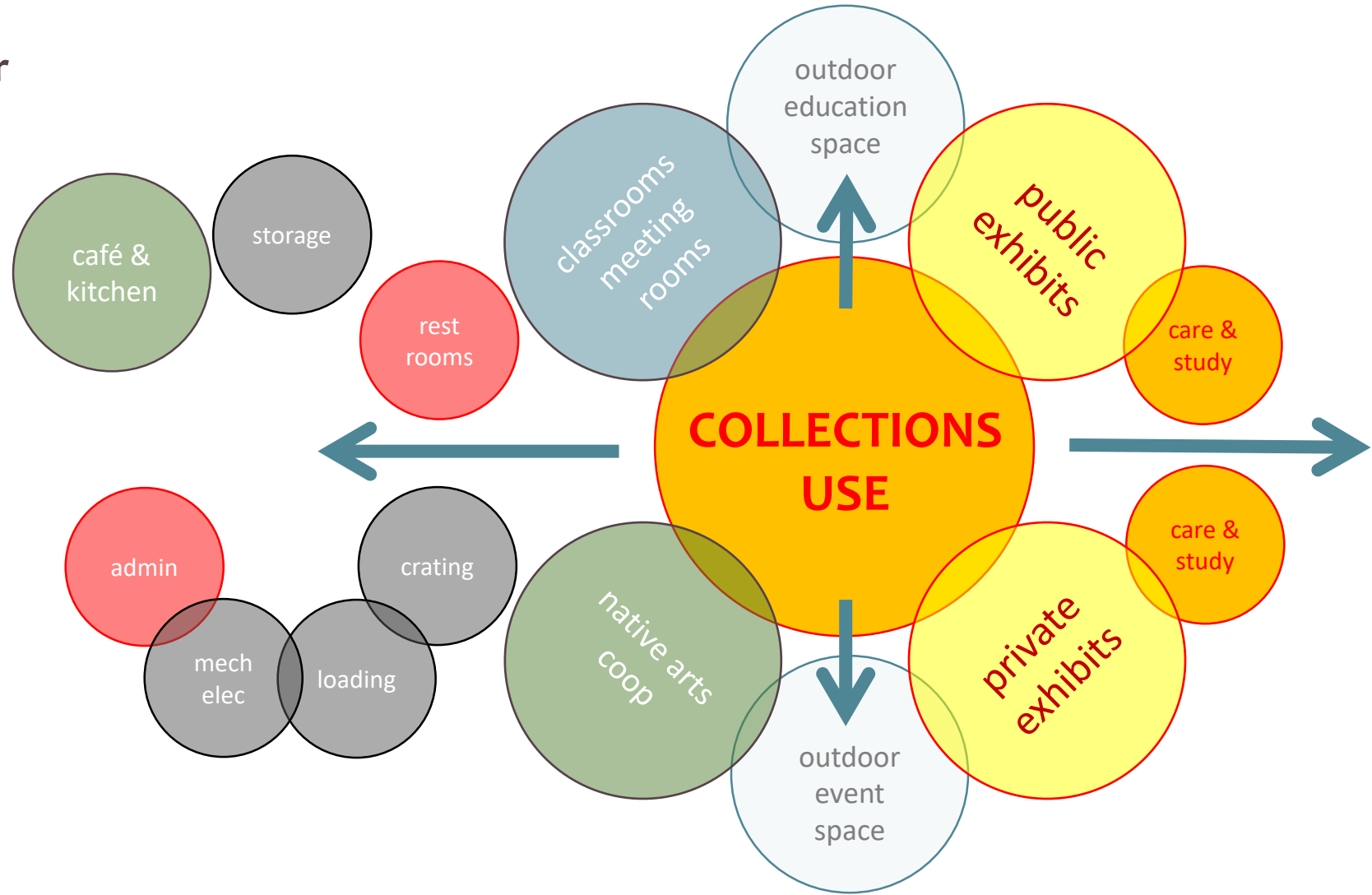


Image source: <https://ramonasakiestewa.com/national-museum-of-the-american-indian//>

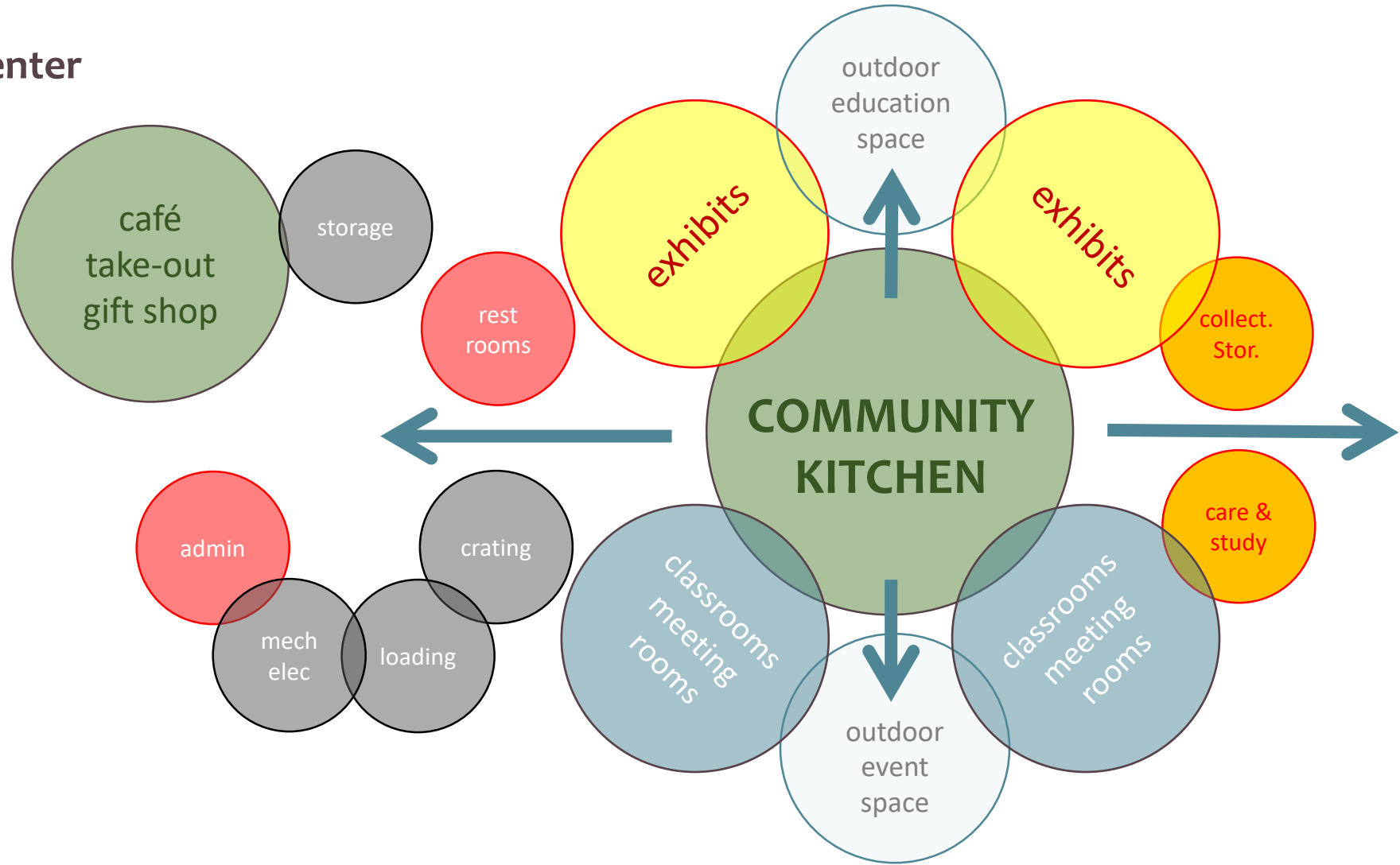
Back to the Center



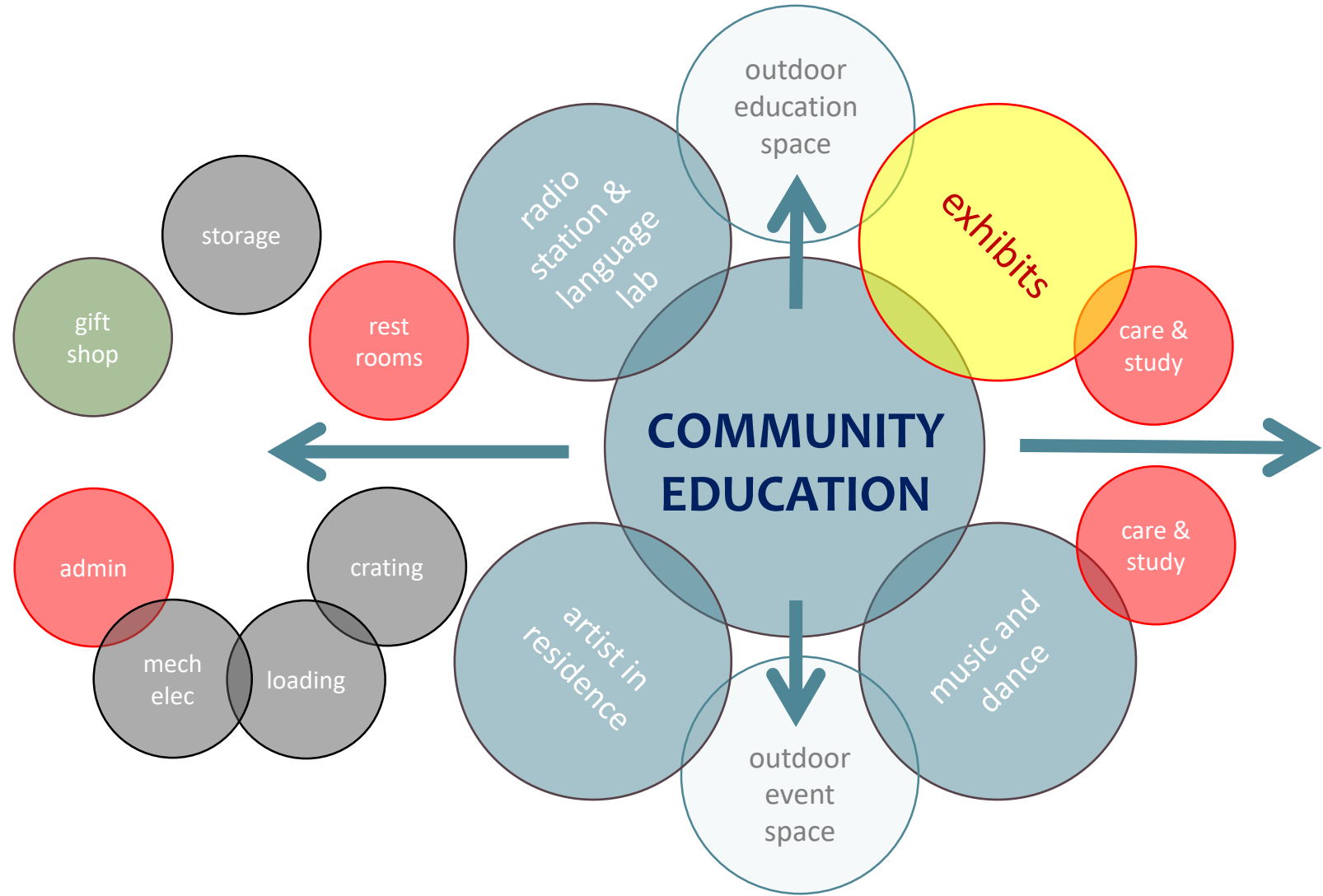
Back to the Center



Back to the Center



Back to the Center

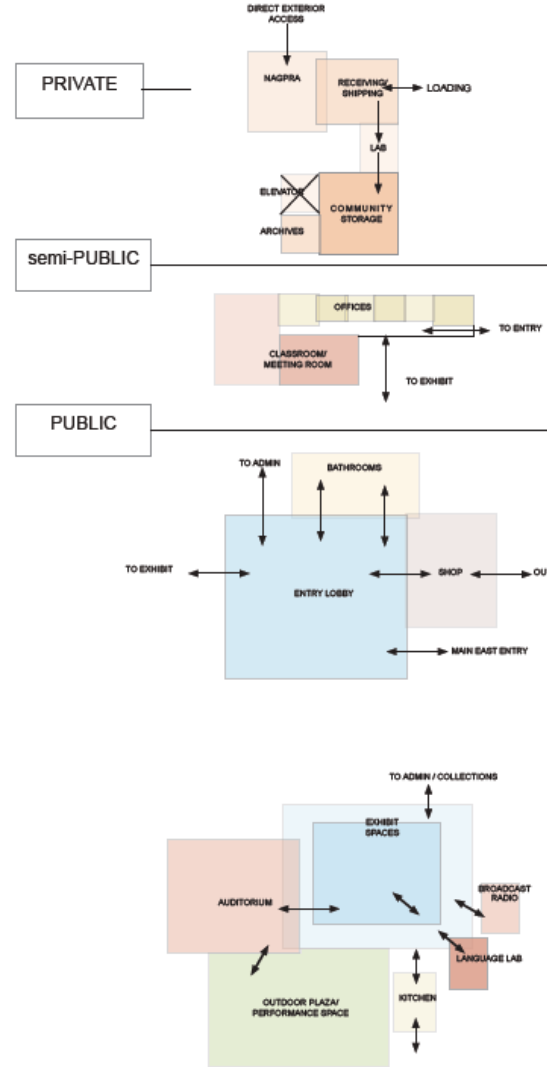


CASE STUDY



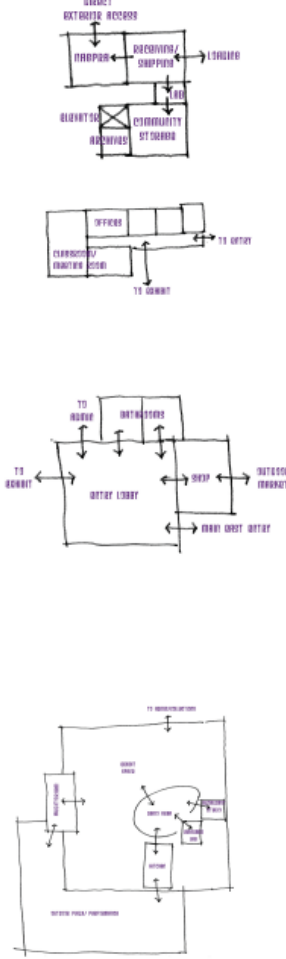
Image source: AOS Architects

Program Adjacency Diagram

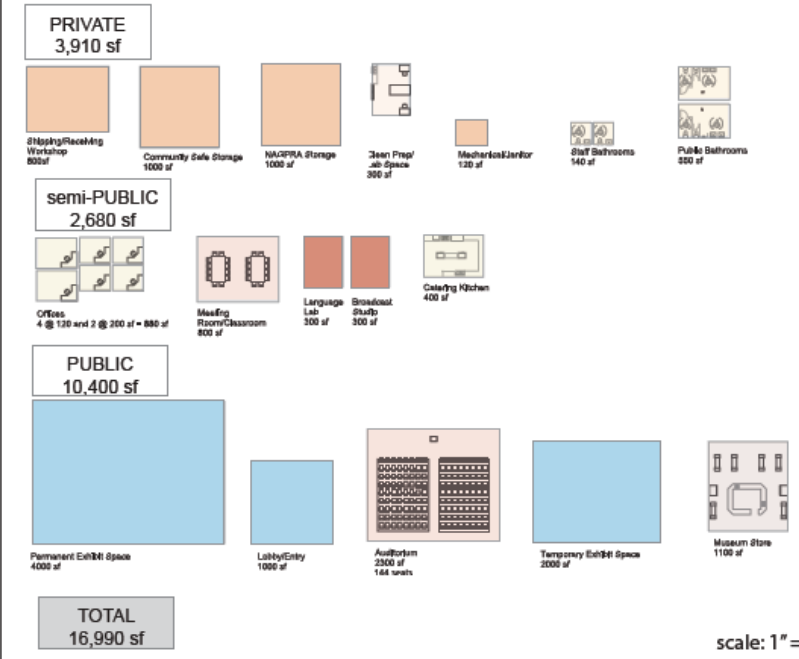


scale: 1" = 20'-0"

SKETCH



Program Layouts + Proposed Program

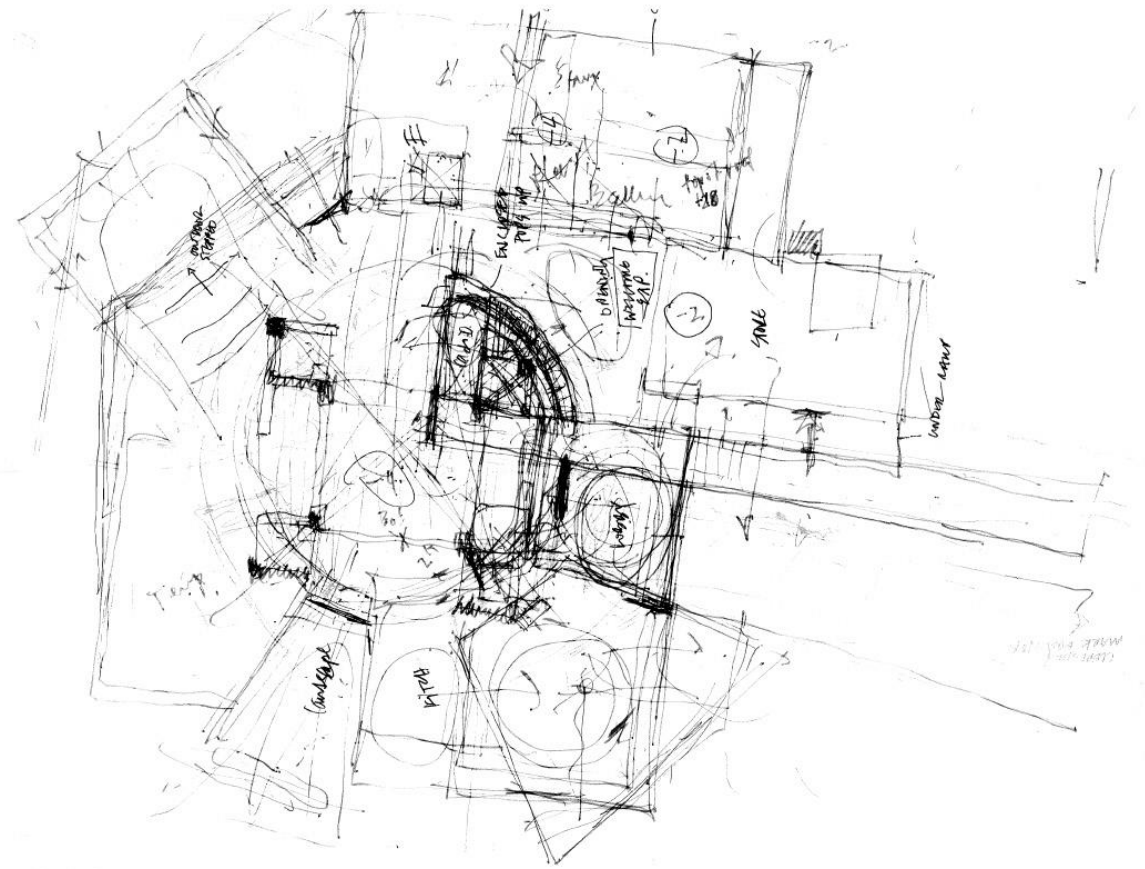
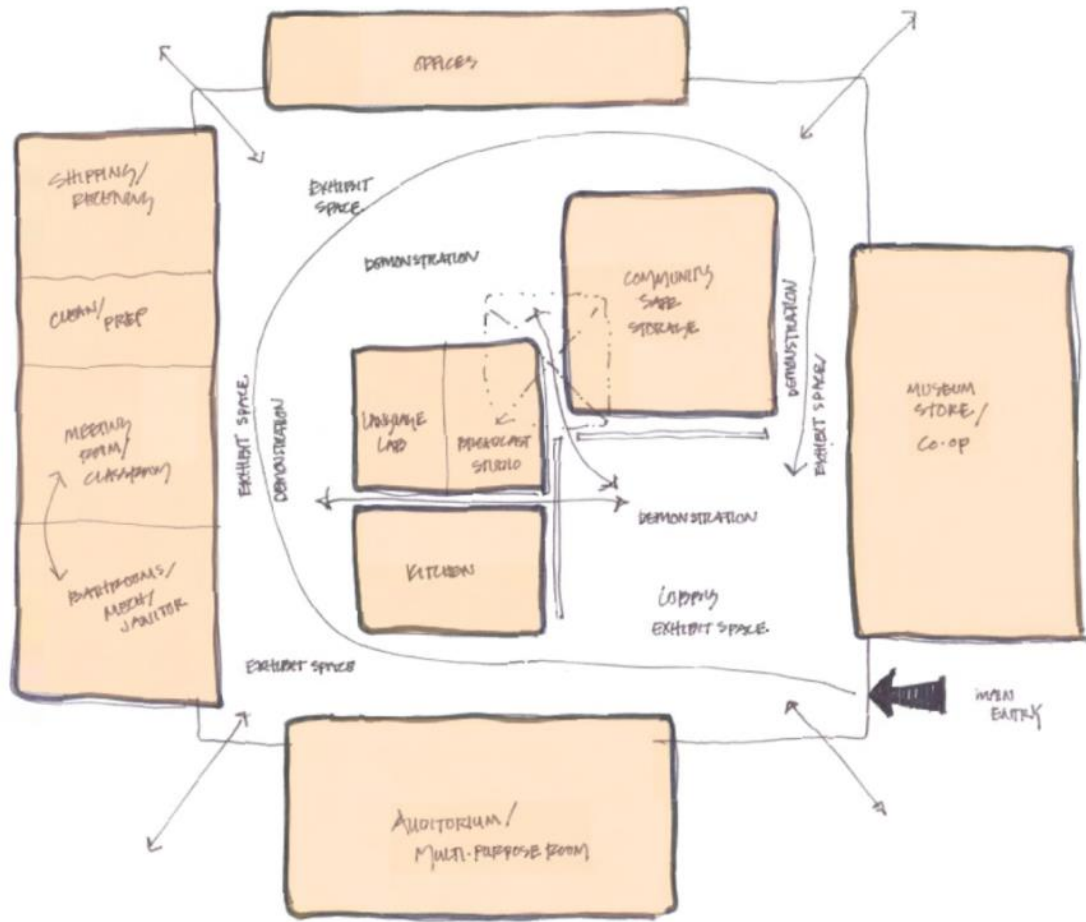


scale: 1" = 20'-0"

FITTING PROGRAM IN 16,600 sf



scale: 1" = 40'-0"











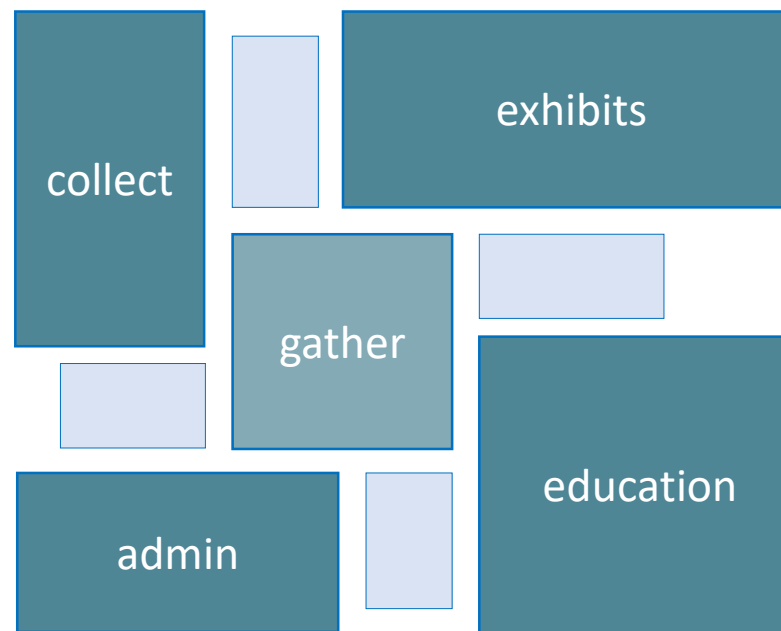




PROTOTYPING – AVOIDING THE COOKIE CUTTER

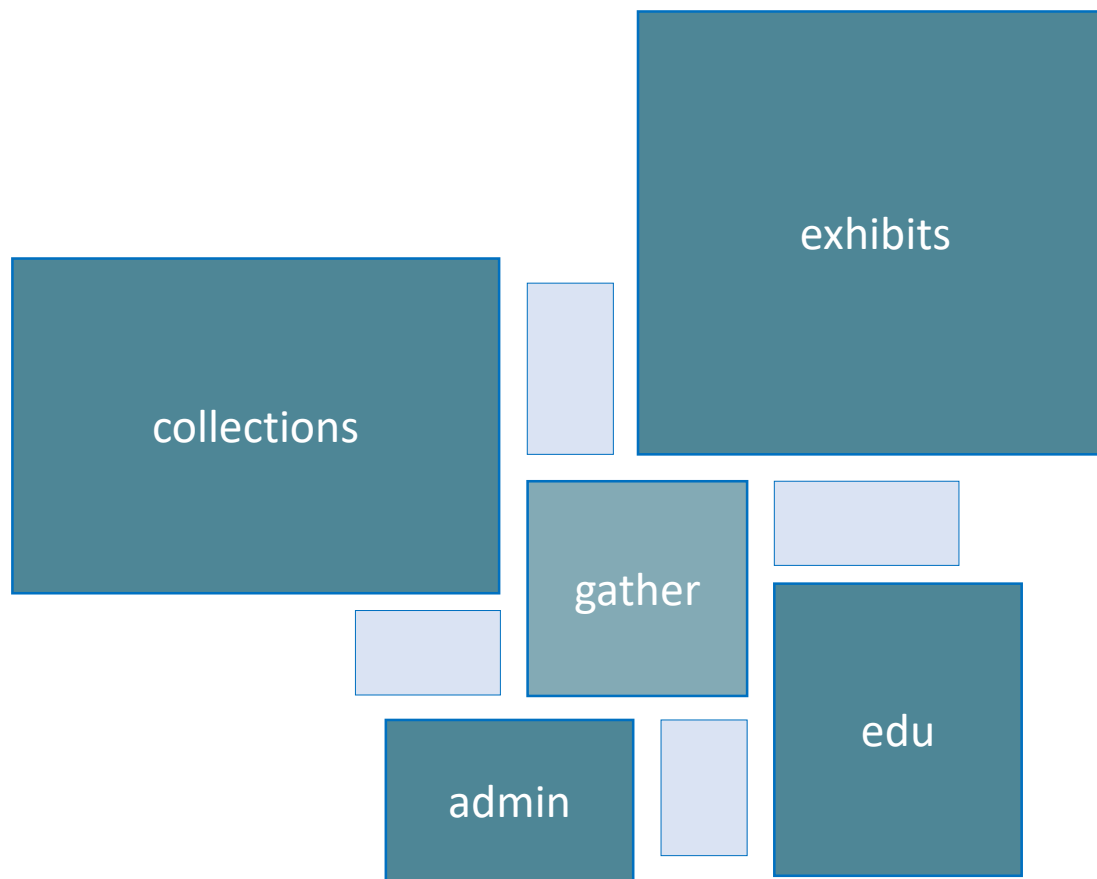
Back to the Center

Prototyping



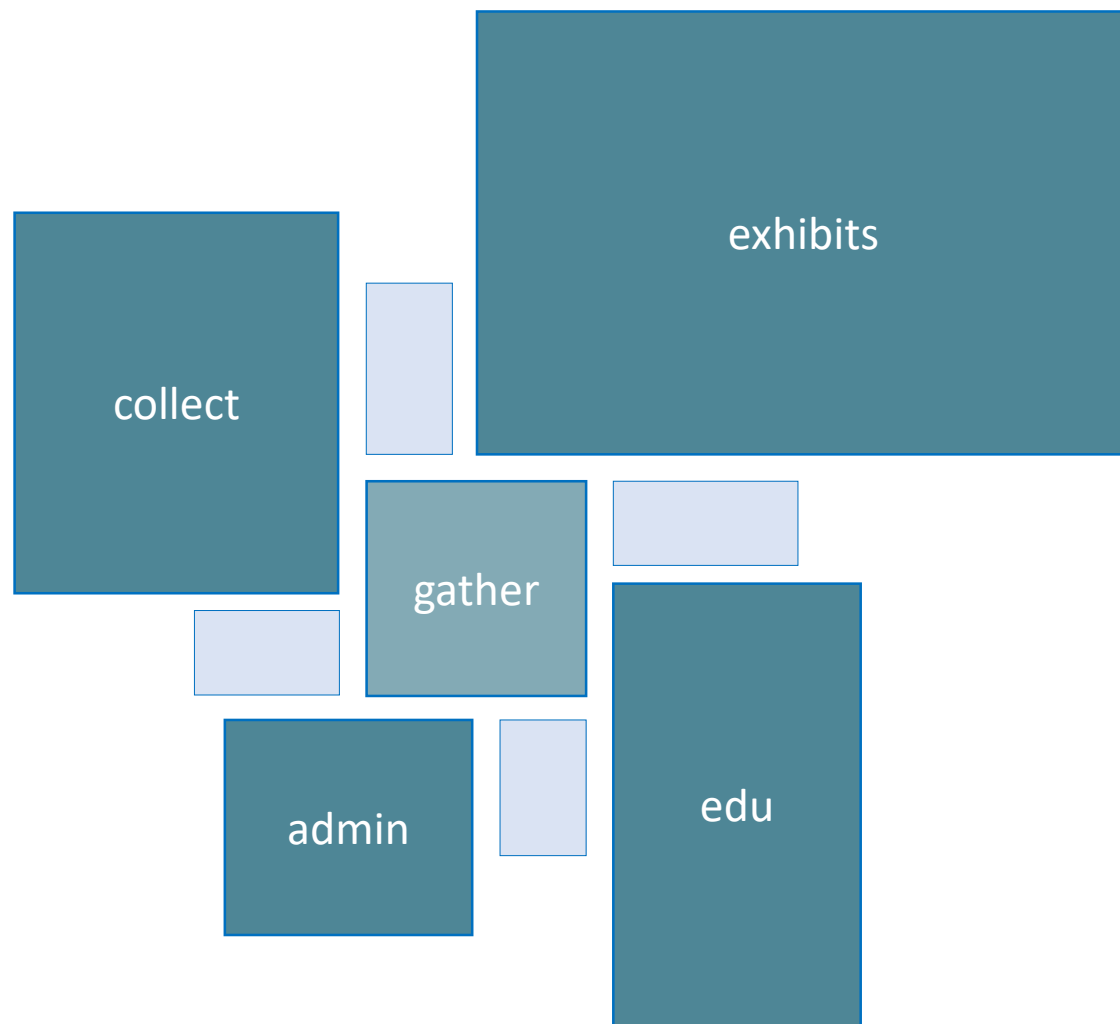
Back to the Center

Prototyping



Back to the Center

Prototyping



NEXT WEEK

4. Site Selection, Analysis, & Design

Presented by: **Samuel Olbekson, AIA, NCARB, AICAE**
Principal
Cunningham Group
Minneapolis, MN

Minneapolis, MN

, MN

, Inc.

Minneapolis, MN

FOR SUPPORTING
DOCUMENTS, VISIT

[HTTP://WWW.ATALM.
ORG/NODE/440](http://www.atalm.org/node/440)



Culture Builds Communities

Thank you for watching this tutorial. If you have questions, please email president@atalm.org.

To view helpful resources, visit www.atalm.org